



INSTALLATION AND OPERATING GUIDE

For

Model 802
Electric Heater



This guide is intended to help you install and care for your Wickes electric heater. Please read carefully before installing and using your heater.

Important

Please keep your Guide in a safe place for future reference

CUSTOMER CARE

All our heaters are designed to meet the most stringent quality, performance and safety requirements to provide our customers with many years of trouble free service. This guide aims to improve your understanding and appreciation of your new heater, by providing simple and informative instructions to enable you to install it and to ensure that you benefit from the excellent performance and features it has to offer.

IMPORTANT SAFETY INSTRUCTIONS

It is important that the following safety instructions are followed

Always

Always install the heater in accordance with the instructions, if in doubt obtain expert advice.

Always make sure the electrical socket is accessible and located adjacent to, but not above the heater.

Always disconnect the heater from the electrical supply before carrying out cleaning, maintenance or replacing lamps.

Always make sure the heater is firmly secured to the fireplace opening to prevent the fire from being tipped over.

Always use a fireguard when young children and infirm persons can come into contact with the heater.

Always use genuine spares.

Never

Never leave children unsupervised in a room where the heater is on and unguarded.

Never obstruct or cover the fan outlet or force items into heater openings.

Never install or use the heater anywhere where water is in use, i.e. bathrooms, shower rooms etc.

Never use aerosols on or around the heater.

Never route the mains supply cable under carpet etc.

Never install the heater close to curtains or combustible materials.

Never use the heater to dry clothes etc.

INSTALLATION

Location

This heater is intended for use in a fireplace opening generally conforming to British Standard 1251 for a nominal 400mm (16 inch) or 450mm (18 inch) Fireplace. It may also be located in other fireplace openings or in a wooden surround, where the following dimensions are available.

Width	390 – 450mm
Height	555 – 590mm
Depth	At least 75mm

Installing

The heater must be fixed into position to prevent it from being tipped over.

The following fixing options are available. The parts required for both fixing options are included with all appliances.

Screw fixing

Wire fixing

The heater must not be located under a fixed electrical socket, the socket must always be accessible in order to disconnect the heater from the electrical supply for maintenance or when replacing a lamp.

Important! This appliance must be earthed.

This heater is supplied with a 3 pin 13A fused rewirable plug with a 1mm² 3core mains flex.

If the plug is not suitable for your socket, remove the plug and fit an appropriate plug. **If in doubt, consult a qualified electrician.**

The wires in the mains lead are coloured in accordance with the following code:-

Green & Yellow = Earth

Blue = Neutral

Brown = Live

As the colours of the wires in the mains lead may not correspond with the coloured markings identifying the terminals in your plug, fit the wires as follows:-

The wire which is coloured **Green & Yellow** must be connected to the terminal in the plug which is marked with the letter **E** or by the earth symbol  or coloured **Green** or **Green & Yellow**.

The wire which is coloured **Blue** must be connected to the terminal which is marked with the letter **N** or coloured **Black**.

The wire which is coloured **Brown** must be connected to the terminal which is marked with the letter **L** or coloured **Red**.

If the mains cable is damaged then, for your safety, it must be replaced with an approved cable your authorised service agent or a qualified electrician.

The mains supply cable must be safely routed from the heater to an electrical socket. Provision is made for left/right or rear cable entry. Using one of the three cable guides at the base of the heater. To relocate, open the appropriate latch on the cable guide and refit the mains cable into the required position.

The heater body should be fixed in position before the front surround is finally fitted.

Please study the illustrations carefully to avoid damage to the heater.

Front Removal

Carefully remove the front surround by removing the two trim fixing screws and lifting upwards and forward – See figure 1

Keep the front surround and screws in a safe place when installing the fire.

Offer the heater body to the fireplace opening to ensure that it will fit before continuing with the installation.



Figure 1

Appliance Fixing

Method A – Screw Fix

There are two slots in the top flange – See figure 2. Mark the fixing position through the slots. Remove the heater. Drill a hole with a No.12 drill bit at each marked position. Insert the wall plugs provided. Reposition the heater body and screw through the slots to provide a secure fixing.

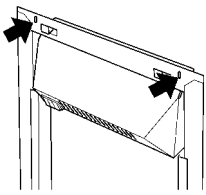

Figure 2

Method B – Wire Fix

The fixing kit includes a steel wire and eyebolt to attach the heater to the back of the fireplace opening.

Mark the position for the eyebolt at the back of the fireplace opening equal to the centre line of the heater and at a height of 533 – 560mm. Drill, plug and screw in the eyebolt – See figure 3.

Thread one end of the steel wire through the two holes in the top flange, passing the wire through the eyebolt and out through one of the opposite holes on the top flange – See figure 3.

Locate the heater into the fireplace opening, then by gently pulling the steel wire, gather up the excess until the heater is firm.

Thread the wire back through the remaining hole to lock the wire and heater in place – See figure 3.

If fixing through marble, ensure that both wallplug and screw pass freely through the marble.

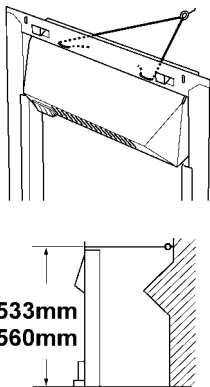

Figure 3

Secondary Screw fixing

If felt beneficial, the appliance can be additionally secured by screws through the side flanges – see figure 4.

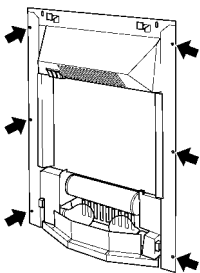

Figure 4

Fitting the Front

Carefully lift the front surround. Hook the front surround onto the retaining plates on the heater body and lower the front surround down – See figure 5.

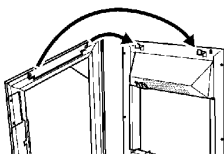

Figure 5

Final Assembly

Fix the sides of the front surround to the heater body with the two screws provided.

Place the front casting/fuel support in position by passing the screw heads through the key hole slots in the surround and lowering down – See figure 6.

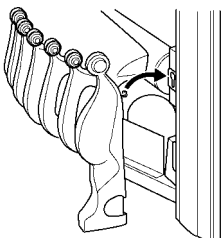

Figure 6

Fuel Effects

Open the polythene bag containing the loose coals and place them on and in front of the coal support to give the most pleasing effect. It is not necessary to use all the coals supplied.

Place the ash pan into position below the casting.

OPERATING YOUR HEATER

Never cover the heater - there is a risk of fire if covered.

The heater is operated by three switches, located below the canopy.

Switch 1 = O  Main On – Off
In the On position only the fuel effect light operates

Switch 2 =  1 kW fan heat setting and fuel effect

Switch 3 =  2 kW fan heat setting and fuel effect

The switches are mechanically interlocked, so when switch 1 is turned off, all switches turn off.

MAINTAINING YOUR FIRE

Always disconnect the heater from the electricity supply by removing the 3 pin plug and allowing the heater to cool before undertaking maintenance or replacing lamps.

Lamp Replacement

The lamps fitted to this heater are long life types, but due to the indeterminate life span and ease of replacement are specifically excluded from the guarantee.

To replace a lamp.

Remove the accessible loose coals. Unhook the front casting by lifting slightly to disengage the unit from the keyhole slots in the trim and gently pull forward – See figure 6.

Replace with a **60W (maximum) clear Edison screw** lamp. Do not use opaque or coloured lamp bulbs.

Refit the front castings and relocate the coals.

Automatic Cut Out

A cut out is fitted to the heating element to prevent damage due to over heating. If it operates due to an obstruction in the airflow, the heater must be turned off and allowed to cool for 15 minutes with the obstruction removed before restarting.

Care and Cleaning

The canopy trims and glass parts need only to be wiped clean with a dry soft cloth, do not use polishes or abrasive materials.

Fault Finding

No or low light from the fuel effect: Possibly due to a lamp failure. Remove the lamp as detailed above and check it in a table lamp that is known to work.

No heat or light: Check the wall socket by plugging in a known working appliance. If functional check the 13A fuse in the heater plug. If either fuse or socket is suspected, have them checked by an electrician.

Light but no heat: The automatic cut out, may have operated, see above.

Disposal

At the end of the products serviceable life it should be disposed of thoughtfully and safely in accordance with local authority regulations. The plug should be removed from the mains cable. We suggest that you cut the mains cable from the heater to prevent any future unsafe use of the appliance.

Wickes Helpline

If you require any further assistance please call the **Wickes Helpline** on **0161 366 4224**

To help us quickly help you, please try to have the following information available before you contact us.

- **Your Post Code**
- **Type of Fire**
- **Model / Name**
- **Serial Number**
- **The fault, problem or request**