

## *S32/6130G Multi-port female branch tees*



### ***The perfect choice for saving costs on installation time and materials***

- *Uses 1 fitting instead of 4 separate*
- *Saves on materials, preparation and installation time*
- *Can be installed in a quarter of the time*
- *Saves space*
- *Manufactured from gunmetal in sizes from 67mm to 108mm*
- *2, 3 or 4 port options available*
- *Fast and efficient press-fit jointing suitable for use with:*
  - *Copper tube and copper alloy tube to BS EN 1057 R250 and R290*
  - *Carbon tube to DIN 2394/NEN 1982*
  - *Stainless steel tube to BS EN 10312/DVGW W541*



# S32/6130G Multi-port female branch tees

**Why use 4 fittings when 1 will do and you can save 75%\* on installation time?**

**Savings compared with a typical installation:**

- 3 tees saved
- 6 less joints to press
- 3 less tube cuts to make
- 768mm less space

\*Timings are benchmark indications only.

## Multi-port in detail:

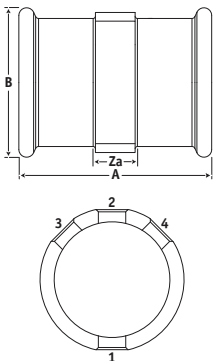
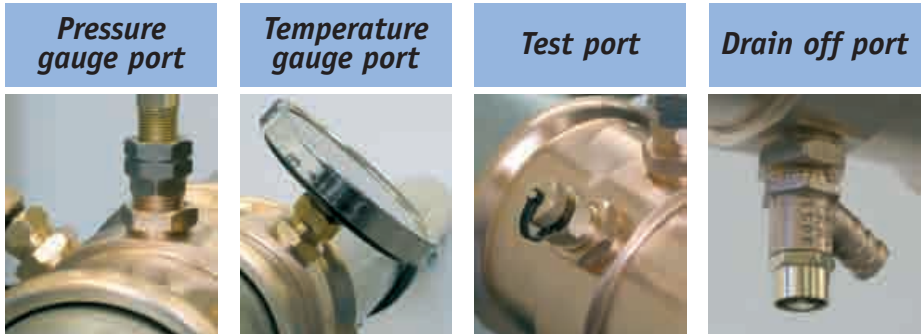

**S32/6130G Multi-port female branch tees**

Description	Dimensions (mm)			Hole number with female BSP thread				Order code	£ each
	A	B	Za	1	2	3	4		
67 x 1/2" (2 x Ports)	130	84	29	1/2"	1/2"	-	-	38189	£142.99
76 x 1/2" (2 x Ports)	130	96	28	1/2"	1/2"	-	-	38188	£160.53
89 x 3/4" (3 x Ports)	160	108	36	3/4"	3/4"	3/4"	-	38192	£191.77
108 x 3/4" (4 x Ports)	170	132	35	3/4"	3/4"	3/4"	3/4"	38206	£211.56

**Pegler Yorkshire Group Limited**  
 St. Catherine's Avenue, Doncaster, South Yorkshire, DN4 8DF, England.  
 Tel: 0844 243 4400 Fax: 0844 243 9870 Brochure hotline: 0800 156 0020

[www.pegleryorkshire.co.uk](http://www.pegleryorkshire.co.uk)



Pegler Yorkshire

