



Push-fit solutions



Pegler Yorkshire

Unrivalled quality, innovation, customer service and long-term value for money

As part of the global Aalberts Industries NV Group, Pegler Yorkshire is one of Britain's largest and most respected manufacturers of innovative products for the demanding and diverse plumbing and heating industries.

Pegler Yorkshire – a unique story

It was in the late 19th century when two separate and altruistic companies set out on the long road to satisfying the needs of prospective customers and, of course, to profit in the process. Coincidentally located just 30 miles apart, each was driven by the same vision and ideals of a no-compromise culture. Cutting corners was never an option and only the best could ever be good enough.

These two companies were Pegler and Yorkshire Fittings. Although in meeting all the challenges of the 20th and 21st centuries each has changed a great deal, the business ethos common to both never has. And now these two like minds have come together as Pegler Yorkshire – a single source of proven, flow control solutions for installers, specifiers and engineers in the domestic, public and commercial markets.

Reputable and established brands

Just as Pegler and Yorkshire have endured over such a long period, many of the brand names they have created over time are similarly very well established, in many cases as market leaders in their respective categories. The very extensive Pegler Yorkshire product range now comprises more than 15,000 lines – without rival for the choice and coverage it offers and for the number and scope of applications it satisfies.

A mind for innovation

Brands which endure and are not easily displaced must by definition be the product of innovative thinking and technology that continually stand the test of time. Pegler Yorkshire's no-compromise philosophy will always put new product development high on the agenda, based on not only meeting the needs of today's markets, but also anticipating and meeting customers' future needs.

The true value of knowledge

As well as the benefit of unparalleled experience of the flow control market and its growth over many decades, Pegler Yorkshire has strong associations with major industry bodies such as those responsible for determining product and performance standards.

The result is a comprehensive store of knowledge and reference which is invaluable in the key areas of research, development and dealing efficiently and accurately with customer enquiries – particularly with regard to product application and suitability.

A charter for the best in customer service

With so diverse a product range and customer base, Pegler Yorkshire's no-compromise standards of quality, reliability and value for money naturally go hand in hand with the principle of delivering the best in customer service.

Green awareness and responsibilities

Developing products which reduce the carbon footprint by saving water and energy is only one side of the green issues coin. Pegler Yorkshire is also increasingly committed to recycling key production materials (such as brass), eliminating the need for excessive packaging wherever possible, and looking for new ways in which the company's day-to-day operations can be improved to reduce waste and minimise the impact on the environment.

Likewise, social responsibilities such as supporting employee and local community welfare are aspects of the very fabric and philosophy upon which both Pegler and Yorkshire were founded.

Standards

Pegler Yorkshire are dedicated to designing, developing and manufacturing products of the highest quality. We are members of numerous standards committees and take an active part in their development. Our products, where applicable, comply with the relevant British, European and International standards. Whatever the latest developments, we guarantee that our products will always meet the latest and highest standards.



Trade bodies

Pegler Yorkshire is pleased to be associated with several influential industry organisations:



Association of Plumbing and Heating Contractors



The Bathroom Manufacturers Association



Construction Products Association

Brass

The Brass Page for specifiers, designers, engineers and manufacturers



British Plumbing Employers Council



Builders Merchants Federation



The Copper Development Association



The UK Copper Board



Institute of Plumbing



Heating and Ventilating Contractors Association



Thermostatic Mixing Valve Manufacturers Association

Thermostatic Mixing Valve Manufacturers Association



Scottish and Northern Ireland Plumbing Employers Federation



This data book has been produced in clearly defined sections to help the user to find relevant information quickly and easily. At the foot of each page there is a reminder of the brochure sections with the relevant page numbers.

Section 1

Product range overview

Introduction to Tectite	4
Key features and benefits	6-8
Tectite Sprint	6
Tectite Classic	6
Tectite Pro	7
Tectite 316	7
Tectite Advance	8
Tectite quarter turn ball valves	8
Tectite service valves	8
Tectite flexible hose connectors	8
Tectite accessories	8
Standards, approvals and guarantees	9

Section 2

Product range details

Sizes, dimensional details and product codes	10-49
--	-------

Section 3

Technical Data

Fitting and tube compatibility	50
Fitting applications	50
Materials specifications	51
Manufacturing standards	51
Working temperatures and pressures	52
Tubes, pipe and their compatibility	53-54
System design considerations and tube expansion	55-57

Section 4

Installation instructions

Socket depths	58
Preparation	58
Preliminaries – 10mm to 28mm sizes	58
Copper, chrome plated copper,	58
Stainless steel System and carbon steel System tube	
PB and PEX pipe	59
Plastic coated carbon steel System tube	59
Jointing	60
Preliminaries – 35mm to 54mm sizes	61
Demounting	62
Disassembly	63

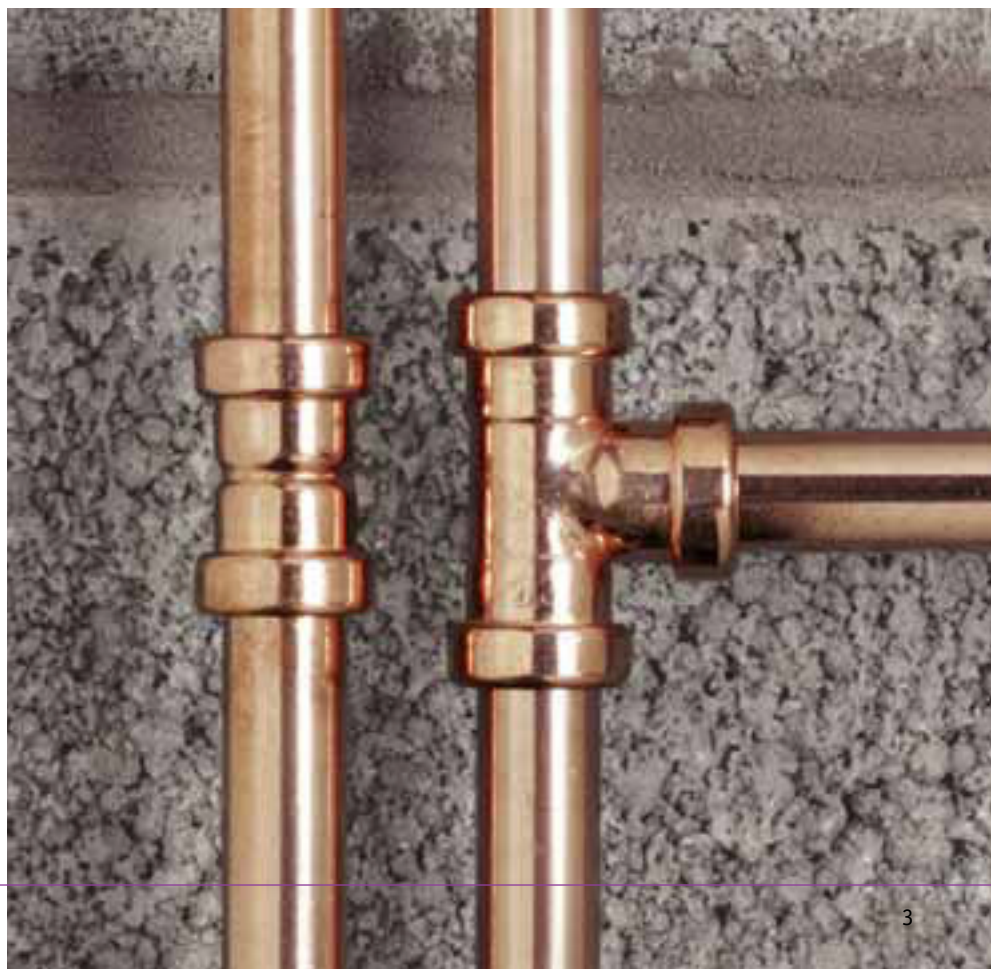

Tectite fittings from Pegler Yorkshire makes jointing easier, faster and more cost effective than other jointing methods – a fittings system which simply pushes together in seconds to create a perfect joint, every time.

Tectite push-fit benefits

A completely heat-free system offering the following benefits:

- Improved installation time over traditional methods
- No naked flames (improved safety)
- Perfectly clean internal bore (less finishing/cleaning required)
- No localised annealing from high temperature working.
- No carbon deposits (less risk of corrosion)
- System does not need to be “dry” for effective jointing

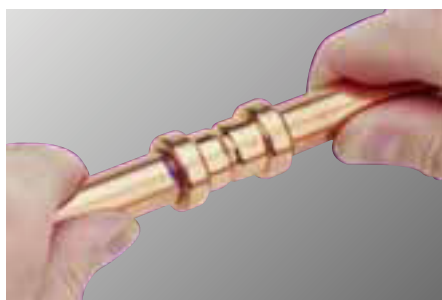

Versatility and choice



A wide range of fittings for use with many different types of materials, including copper tube, PEX and PB

pipe, and a variety of steel including stainless and carbon.

Choice of demountable or non-demountable fittings.



Time-saving and cost-saving installation

Time-saving and cost-saving installation of many types of plumbing and heating services – for commercial, domestic and public utility applications – including:

- All above-ground hot and cold domestic and commercial water services
- Heating and chilled water services (potable and non-potable)
- Low-temperature hot water and heating
- Smallbore or minibore central heating systems
- Pressurised, vented and unvented heating systems

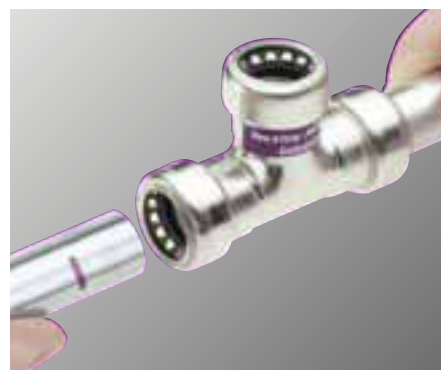

The perfect solution all round

A heat-free, time saving jointing method which guarantees uncontaminated installation. Ideal for applications as diverse as domestic maintenance and refurbishment, new build and large-scale public sector projects.

Renowned Pegler Yorkshire quality and reliability

Renowned Pegler Yorkshire quality and reliability – with some Tectite products offering the bonus of an enhanced 30-year warranty. Pegler Yorkshire also operates a Quality Management System for the development, manufacture and supply of fittings, tube, valves and accessories which complies with the requirements of BS EN ISO 9001:2000.

Key to symbols

Products in this brochure are accompanied by symbols intended to aid the reader by stating their ideal environments. These symbols are:

- ☑ Heat free
- ◀▶ Demountable
- ✖ Non-demountable
- ☑ Potable water applications
- ☒ Not suitable for potable water applications
- ☑ Gas installation applications
- ☒ Not suitable for gas installation applications
- ❄ Chilled water services
- ☑ Closed circuit heating
- ⚡ Electrical continuity
- 🔥 Hot water services
- 🚰 Reduced requirement for flushing
- 🔧 Galvanised or nickel plated
- 🔧 No tools required
- ⌚ Saves installation time
- 📦 Easy to insulate
- 📦 Easy to install in confined areas
- 🔄 Can be rotated



Tectite
SPRINT

Tectite Sprint non-demountable fittings are ideal for fast and efficient heat free jointing, offering a visually appealing, low profile design which can be easily installed in confined spaces. They are also easy to insulate.

Features

- Available in sizes 10mm to 28mm
- Manufactured from copper or machined DZR brass
- Can be used with copper tube, PB and PEX pipe (with liners) or chrome plated copper tube
- Suitable for use on hot and cold water services, heating and chilled water applications and low temperature hot water services
- Provides electrical continuity
- WRAS approved*

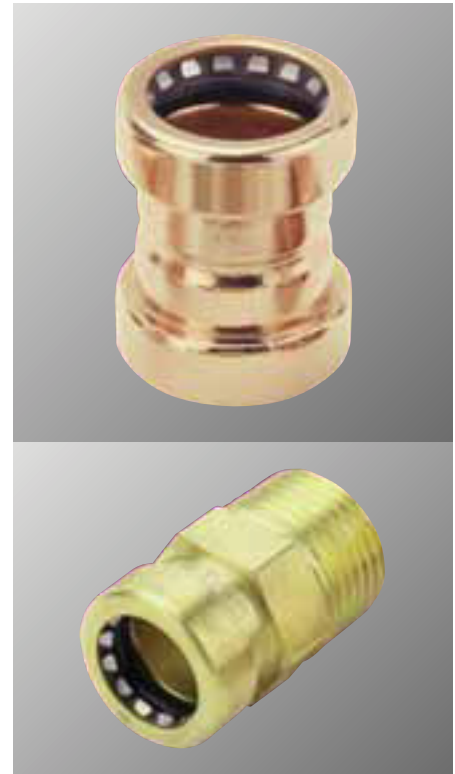
**Tectite**
CLASSIC

The original Tectite fitting and proven in the field for over 15 years, Tectite Classic can be used for similar applications to Tectite Sprint but where a demountable fitting is required.

Features

- Demountable
- Available in sizes 10mm to 28mm
- Manufactured from gunmetal, A-metal or DZR brass
- Can be used with copper tube, PB and PEX pipe (with liners) or chrome plated copper tube
- Suitable for use on hot and cold water services, heating applications and low temperature hot water services
- WRAS approved*



*On certain sizes

Tectite
PRO

Tectite Pro demountable fittings have been specially developed to meet the rigorous demands of the mechanical services sector. Tectite Pro offers enhanced performance over an extended size range and is WRAS approved. 15mm to 54mm fittings feature a stainless steel grab ring.

Features

- Demountable
- Available in sizes 15mm to 54mm
- Manufactured from gunmetal, A-metal or DZR brass
- Provides electrical continuity
- Can be used with copper tube, PB and PEX pipe, chrome plated copper tube or carbon steel tube
- Designed for use in the mechanical services sector on hot and cold services, heating and chilled water applications and low temperature hot water services
- Provides enhanced performance
- WRAS approved

**Tectite**
316

Tectite 316 is a stainless steel option which has been developed for use with 316 System tube for potable water applications where water quality and hygiene are key considerations. The Tectite 316 range incorporates a stainless steel grab ring which has been specifically developed to grip stainless steel tube without the need to for it to be scribed.

Features

- Demountable
- Available in sizes 15mm to 54mm
- Manufactured from 316 stainless steel
- Provides electrical continuity
- Can be used with 316 System tube
- Designed for use for potable water services in the food processing and pharmaceutical industries
- WRAS approved



Tectite
ADVANCE

Designed for use in conjunction with XPress carbon steel System tube, the non-demountable Tectite Advance System is five times quicker to install than a traditional screwed steel installation*. With installed cost savings of up to 70%, borne out in an independent industry report, Tectite Advance can help to deliver projects on time and within budget.

*Research carried out in conjunction with Leeds College of Building, February 2007.

Features

- Available in sizes from 15mm to 54mm
- Manufactured from galvanised carbon steel
- Provides electrical continuity
- Can be used with XPress carbon steel System tube and plastic coated XPress tube
- Light weight and easy to fit
- Designed for use with unvented closed circuit heating and chilled water services (closed loop)

**Tectite****Tectite Pro quarter turn ball valves**

Tectite Pro quarter turn ball valves are a safe, reliable and cost effective way to control the flow of water.

Features

- Available in sizes from 15mm to 22mm
- Manufactured from brass with nickel plated finish
- Designed for use with hot and cold water services and heating systems

Tectite Classic and Tectite Pro servicing valves

Tectite Pro servicing valves allow sections of pipework to be isolated for repair or maintenance without the need to drain down the system. They incorporate a simple open/shut mechanism which can be operated with a screwdriver or coin.

Features

- Available in 15mm sizes
- Manufactured from brass with a chrome plated finish
- Provides electrical continuity

- Designed for use in hot and cold water services
- Ideal for use with terminal taps and float valves

Tectite flexible hose connectors

Tectite flexible hose connectors are suitable for use in areas where space is limited and the fitting of rigid tube is difficult.

Features

- Available in 15mm sizes
- Manufactured with high quality stainless steel braided EPDM hose
- Designed for use in hot and cold water services and on fan coils
- WRAS approved

Tectite accessories

The Tectite range is complemented by a variety of accessories. These include deburring/scribe tools, disconnecting tools and clips, pipe clips, demounting end caps, grab rings and lubricant.



It's Pegler Yorkshire's policy to provide a range of products and services which meet, or exceed, the requirements of our customers in respect of quality, cost and delivery.

Standards and approvals

WRAS All Tectite Sprint, Tectite Classic, Tectite Pro and Tectite 316 fittings are listed and comply with the requirements of the United Kingdom Water Regulations/Byelaws (Scotland).

DVGW Tectite Classic and Tectite 316 fittings have been approved by the German approval authority. They comply with DVGW Arbeitsblatt W534, which covers fittings and joints for tubes in potable water installations.

Tectite Classic fittings are also approved by **KIWA** (Dutch certification), **SITAC** (Norway, Sweden and Finland certification) and **CSTB** (French certification). Tectite 316 fittings are also approved by **SVGW** (Swiss certification).



Tectite-PEX barrier pipe is kitemark approved



The Tectite range has been certified by the WRAS and is audited periodically.



Applicable Tectite products are DVGW approved for the European market.



ISO is achieved through the continuous improvement of our Quality Management System in line with the requirements of BS EN ISO9001: 2000.



Product	PRODUCT APPROVALS									
	WRAS	CSTB	KIWA	DVGW	ETA	ACS	Sintef	Sitac	SVGW	OVGW
Tectite Sprint	✓	-	-	-	-	-	✓	✓	-	-
Tectite Classic	✓	✓	✓	✓	✓	✓	-	-	-	-
Tectite Pro	✓	-	-	-	-	-	-	-	-	-
Tectite 316	✓	-	-	✓	-	-	-	-	✓	✓
Tectite Advance	-	-	-	-	-	-	-	-	-	-

Guarantees

25 YEAR GUARANTEE

Where Tectite Sprint, Tectite Classic, Tectite Pro and Tectite 316 fittings, Tectite-PEX barrier pipe and 316 System tube are installed in pipelines with other products, all are guaranteed against all manufacturing defects for 25 years.

30 YEAR GUARANTEE



Where pipelines are constructed exclusively using Tectite fittings and recommended tubes, the resulting installations will be deemed Tectite Systems and as such qualify for a 30 year guarantee against all manufacturing defects.

Tectite fittings, tube and accessories	Guarantee period (years)			
	5	10	25	30
Tectite SPRINT Fittings	-	-	✓	-
Tectite SPRINT Fittings with Yorkex* copper tube and/or Tectite-PEX pipe	-	-	-	✓
Tectite CLASSIC Fittings	-	-	✓	-
Tectite CLASSIC Fittings with Yorkex* copper tube and/or Tectite-PEX pipe	-	-	-	✓
Tectite PRO Fittings	-	-	✓	-
Tectite PRO Fittings with Yorkex* copper tube and/or Tectite-PEX pipe	-	-	-	✓
Fittings with XPress carbon steel System tube	-	✓	-	-
Tectite 316 Fittings	-	-	✓	-
Tectite 316 Fittings and stainless steel 316 System tube	-	-	-	✓
Fittings with XPress carbon steel System tube	-	✓	-	-
Tectite ADVANCE Fittings	✓	-	-	-
Tectite ADVANCE Fittings with XPress carbon steel System tube	-	✓	-	-
Tectite PRO Tectite Pro quarter turn ball valves	-	-	✓	-
Tectite Tectite Classic and Tectite Pro servicing valves	-	-	✓	-
Tectite Tectite flexible hose connectors	-	✓	-	-

To qualify for guarantees, all products must be installed in accordance with our instructions in specified applications.
*Yorkex is a brand name of Yorkshire Copper Tube.

Push-fit for copper and plastic

Manufactured from copper and DZR brass, Tectite Sprint is ideal for use on hot and cold-water services, in low-temperature hot water and heating.

System PEX Pipe



TP520 Barrier pipe. Straight lengths

Size	Finish	Order code
15mm x 3m	White plastic	60029
15mm x 6m	White plastic	60030
22mm x 3m	White plastic	60037
22mm x 6m	White plastic	60038
28mm x 3m	White plastic	60041
28mm x 6m	White plastic	60042

Suitable for:



TP525 Barrier pipe. Coil

Size	Finish	Order code
12mm x 50m	White plastic	60020
12mm x 100m	White plastic	60021
15mm x 25m	White plastic	60024
15mm x 50m	White plastic	60025
15mm x 100m	White plastic	60026
22mm x 25m	White plastic	60033
22mm x 50m	White plastic	60034

Suitable for:

Push-fit fittings

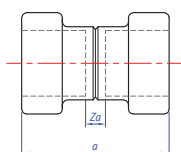

TT1 Straight coupling

Size	a	Za	Order code
10mm	34	2	75500
12mm	36	2	75660
14mm	37	2	75661
15mm	36	2	75501
16mm	36	2	75662
18mm	37	2	75663
22mm	38	2	75502
28mm	40	2	75503

Suitable for:

- For jointing plain and chrome plated copper tube to BS EN 1057, PEX - including Tectite PEX - and PB plastic pipes to BS 7291
- Guaranteed for 30 years against manufacturing defects when installed exclusively with Tectite PEX or Yorkex Copper Tube from Yorkshire Copper Tube Ltd, or for 25 years when used with other products

TT1R Reducing coupling

Size	a	Za	Order code
15 x 10mm	41	8	75504
14 x 12mm	38	5.5	75664
15 x 12mm	39	7	75665
16 x 12mm	40	7.5	75666
16 x 14mm	37.5	5.5	75667
18 x 15mm	37.5	5.5	75668
18 x 16mm	37	5.5	75669
22 x 15mm	42	8	75505
22 x 16mm	42	9.5	75670
22 x 18mm	41.5	7.5	75671

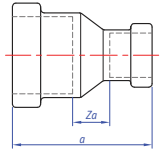

Suitable for:

TT2 Straight female connector

Size	a	Za	S	Order code
10mm x 1/2"	35.5	6.5	25	75672
12mm x 1/2"	35.5	6.5	25	75673
14mm x 3/8"	33	5.5	20	75674
14mm x 1/2"	35.5	6.5	25	75675
15mm x 1/2"	34	17	24.5	75510
16mm x 1/2"	35	6.5	25	75676
18mm x 1/2"	35.5	6	25	75677
22mm x 3/4"	37	19	30	75511
28mm x 1"	41	3	38	75678

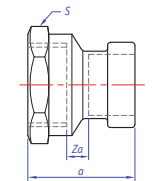

Suitable for:

TT3 Straight male connector

Size	a	Za	S	Order code
10mm x 3/8"	32	17	22	75679
10mm x 1/2"	34.5	19.5	22	75680
12mm x 3/8"	32	16.5	22	75681
12mm x 1/2"	34.5	19	22	75682
14mm x 3/8"	32.5	17	22	75683
14mm x 1/2"	34	18.5	22	75684
15mm x 1/2"	37	20	21	75515
16mm x 1/2"	34	19	22	75685
18mm x 3/4"	38.5	22	27	75687
22mm x 3/4"	39.5	21.5	26	75516
28mm x 1"	43.5	24.5	32	75518

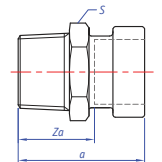

Suitable for:

Push-fit for copper and plastic

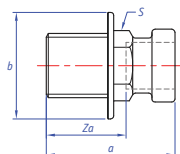

TT5 Tank connector

Size	a	Za	S	b	Order code
15mm x 1/2"	42	25	22	34.8	75520
22mm x 3/4"	46	28	28	42	75521

Suitable for:

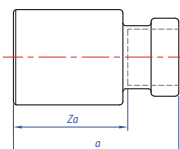

TT6 Reducer

Size	a	Za	Order code
15 x 10mm	37	21	75523
15 x 12mm	37	21.5	75524
18 x 15mm	39	23.5	75520
22 x 14mm	46	30.5	75688
22 x 15mm	39	22	75525
28 x 15mm	43	26	75526
28 x 22mm	44	26	75527

Suitable for:

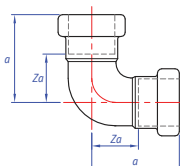

TT12 Elbow

Size	a	Za	Order code
10mm	28	12	75530
12mm	32	15.5	75689
14mm	34.5	18.5	75690
15mm	35	18	75531
16mm	37	21.5	75691
18mm	37.5	22	75692
22mm	44.5	26.5	75532
28mm	52.5	33.5	75533

Suitable for:

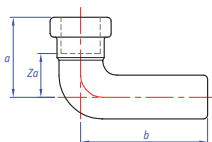

TT12S Street elbow

Size	a	b	Za	Order code
10 x 10mm	28	44	12	75535
10 x 15mm	28	45	12	75536
12 x 12mm	32.5	33.5	16.5	75693
14 x 14mm	35	35	19	75694
15 x 15mm	35	35	18	75537
16 x 16mm	37	37	21.5	75695
18 x 18mm	37.5	42.5	22	75696
22 x 22mm	52.5	50	33.5	75538

Suitable for:

Push-fit for copper and plastic

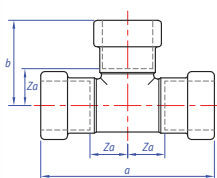

TT24 Equal tee

Size	a	b	Za	Order code
10mm	46.5	23	7	75555
12mm	52	25.5	9	75709
14mm	52.5	26	10	75710
15mm	52.5	26	9	75556
16mm	59.5	29.7	14	75711
18mm	57.5	28.5	13	75712
22mm	62.5	31	13	75557
28mm	72.5	36	17	75558

Suitable for:

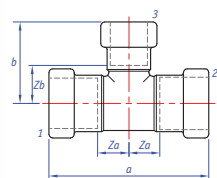

TT25 Tee, reduced branch

Size (1 x 2 x 3)	a	b	Za	Zb	Order code
14 x 14 x 12mm	50	26.5	8.5	10	75713
15 x 15 x 10mm	48	25	7	9	75565
15 x 15 x 12mm	49	27.5	8.5	11	75714
16 x 16 x 12mm	49	27.5	8.5	11	75715
16 x 16 x 14mm	50	26.5	9.5	10	75716
18 x 18 x 12mm	50	29.5	8	13	75717
18 x 18 x 14mm	51	28.5	9	12	75718
18 x 18 x 15mm	54	27.5	10	12	75719
22 x 22 x 10mm	50	29.5	7	13.5	75566
22 x 22 x 14mm	57	30.5	11	14	75720
22 x 22 x 15mm	54	30.5	9	13.5	75567
22 x 22 x 16mm	60	31.5	12.5	16	75721
22 x 22 x 18mm	60	31.5	12.5	15	75722
28 x 28 x 15mm	56	34.5	9	17.5	75568
28 x 28 x 18mm	63	34.5	12.5	18	75723
28 x 28 x 22mm	65	35.5	13.5	17.5	75569

Suitable for:

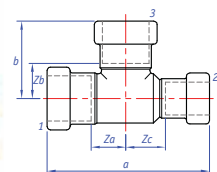

TT26 Tee, one end reduced

Size (1 x 2 x 3)	a	b	Za	Zb	Zc	Order code
15 x 12 x 15mm	60	28	12.5	15.5	12.5	75724
18 x 12 x 18mm	65	31.5	13	19	15	75725
18 x 15 x 18mm	64	30.5	13	18	14	75726
22 x 15 x 22mm	68.5	31.5	13.5	13.5	20	75573
22 x 18 x 22mm	68.5	32.5	14	15	20	75727
28 x 15 x 28mm	77.5	36.5	17.5	17.5	24	75574
28 x 22 x 28mm	78.5	36.5	17.5	17.5	24	75575

Suitable for:

TT27 Tee, one end and branch reduced

Size (1 x 2 x 3)	a	b	Za	Zb	Zc	Order code
16 x 14 x 14mm	54	26.5	12.5	10	10	75728
22 x 15 x 15mm	63.5	30	12	13	13.5	75582
22 x 18 x 18mm	65	33	13.5	16.5	17.5	75729
28 x 18 x 18mm	73	36.5	13.5	20	24	75730
28 x 22 x 22mm	70	34	17.5	15	15.5	75584

Suitable for: 

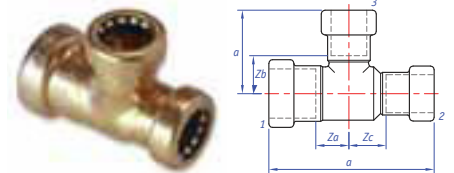

TT61 Stop end

Size	a	Order code
10mm	16	75590
12mm	18	75731
14mm	18	75732
15mm	17	75591
16mm	17	75733
18mm	19	75734
22mm	18	75592
28mm	19	75593

Suitable for: 



TT62 Tap connector

Size	a	Za	Order code
10mm x 1/2"	33	17	75600
12mm x 3/8"	34.5	18	75736
12mm x 1/2"	36.5	20	75735
14mm x 3/8"	37	21	75738
14mm x 1/2"	34	18	75737
15mm x 1/2"	34	17	75601
16mm x 1/2"	36	20.5	75739
16mm x 3/4"	35.5	20	75740
18mm x 1/2"	36	20	75741
18mm x 3/4"	36	20	75742
22mm x 3/4"	38.5	20.5	75603

Suitable for: 

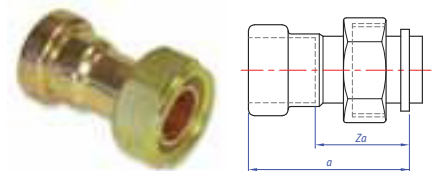

TT63 Bent tap connector

Size	a	b	Za	Order code
10mm x 1/2"	36	24	20	75604
12mm x 1/2"	32.5	24	16	75743
15mm x 1/2"	37	24	20	75605
18mm x 1/2"	40.5	32	24	75744

Suitable for: 

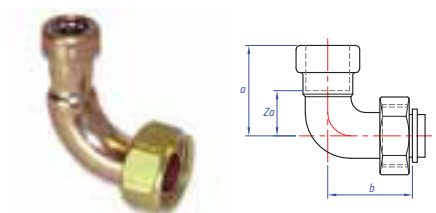

Demountable push-fit for copper and plastic

System PEX pipe



TP520 Barrier pipe. Straight lengths

Size	Finish	Order code
15mm x 3m	White plastic	60029
15mm x 6m	White plastic	60030
22mm x 3m	White plastic	60037
22mm x 6m	White plastic	60038
28mm x 3m	White plastic	60041
28mm x 6m	White plastic	60042

Suitable for:



TP525 Barrier pipe. Coil

Size	Finish	Order code
12mm x 50m	White plastic	60020
12mm x 100m	White plastic	60021
15mm x 25m	White plastic	60024
15mm x 50m	White plastic	60025
15mm x 100m	White plastic	60026
22mm x 25m	White plastic	60033
22mm x 50m	White plastic	60034

Suitable for:

Demountable push-fit fittings

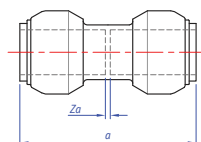

T1 Straight coupling

Size	a	Za	Order code
10mm	49	1	45108
12mm	49	1	45110
14mm	49	1	45112
15mm	49	1	45114
16mm	49	1	45116
18mm	49	1	45118
20mm	59	1	45120
22mm	59	1	45121
28mm	65	1	45123

Suitable for:

T1R Reducing coupling

Size	a	Za	Order code
12 x 10mm	49	1	45155
14 x 12mm	49	1	45157
15 x 10mm	49	1	45159
15 x 12mm	49	1	45161
16 x 12mm	49	1	45163
16 x 14mm	49	1	45165
18 x 15mm	49	1	45167
20 x 18mm	54	1	45168
22 x 10mm	54	1	45170
22 x 15mm	54	1	45172
22 x 18mm	54	1	45174
28 x 22mm	62	1	45178

Suitable for: 

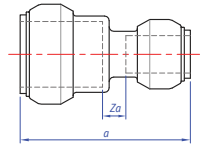

T2 Straight female connector

Size	a	Za	S	Order code
10mm x 3/8"	39	2	22	45190
10mm x 1/2"	40	2	26	45192
12mm x 3/8"	39	2	25	45194
12mm x 1/2"	40	2	25	45196
14mm x 3/8"	39	2	22	45200
14mm x 1/2"	40	2	25	45202
15mm x 3/8"	39	2	22	45204
15mm x 1/2"	40	3	25	45206
15mm x 3/4"	40	1	25	45208
18mm x 1/2"	40	3	25	45210
18mm x 3/4"	43	3	32	45212
22mm x 1/2"	45	2	32	45220
22mm x 3/4"	47	3	32	45222
22mm x 1"	49	2	38	45223
28mm x 3/4"	51	3	32	45224
28mm x 1"	53	1	37	45225

Suitable for: 

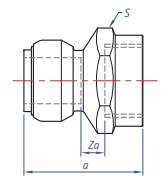

Demountable push-fit for copper and plastic

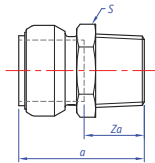

T3 Tapered male connector

Size	a	Za	S	Order code
10mm x 3/8"	39	15	22	45250
10mm x 1/2"	42	18	23	45252
12mm x 3/8"	39	15	20	45254
12mm x 1/2"	40	16	25	45256
15mm x 3/8"	39	16	20	45265
15mm x 1/2"	40	16	22	45267
18mm x 1/2"	43	19	24	45286
18mm x 3/4"	43	19	28	45288
22mm x 1/2"	44	16	28	45290
22mm x 3/4"	46	18	28	45292
22mm x 1"	49	20	34	45294
28mm x 1"	53	21	37	45296

Suitable for:

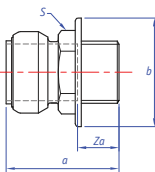

T3P Straight male connector

Size	a	Za	b	S	Order code
12mm x 3/8"	37	13	30	22	45350
14mm x 3/8"	37	13	30	22	45354
14mm x 1/2"	37	14	32	24	45356
15mm x 1/2"	40	17	27	21	45358
15mm x 3/4"	47	23	50	42	45360
16mm x 1/2"	38	14	32	24	45362
22mm x 1/2"	42	14	32	26	45364
22mm x 3/4"	44	15	35	28	45366
22mm x 1"	45	16	42	28	45368
28mm x 1"	48	16	42	32	45370

Suitable for:

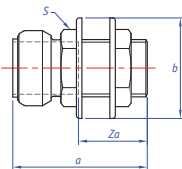

T5 Tank connector

Size	a	Za	b	S	Order code
15mm x 1/2"	49	25	35	22	45390
22mm x 1/2"	53	24	42	28	45394
28mm x 1"	56	24	48	32	45396

Suitable for:

Demountable push-fit for copper and plastic

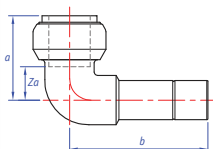

T12SNP Street elbow (nickel plated)

Size	a	b	Za	Order code
10mm	30	42	6	45491
10 x 15mm	33	42	9	45495
15mm	33	44	9	45497

Suitable for:

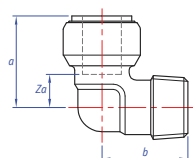

T13 Male elbow

Size	a	b	Za	Order code
10mm x 3/8"	30	24	6	45550
10mm x 1/2"	30	29	6	45552
12mm x 3/8"	32	24	7	45554
12mm x 1/2"	33	29	7	45556
14mm x 1/2"	33	29	9	45560
15mm x 1/2"	33	29	9	45561
16mm x 1/2"	34	29	10	45563
16mm x 3/4"	36	36	13	45564
18mm x 1/2"	34	29	10	45569
18mm x 3/4"	34	36	10	45570
22mm x 3/4"	41	34	12	45576
28mm x 1"	49	42	17	45578

Suitable for:

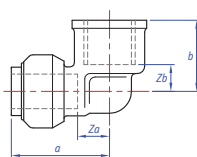

T14 Female elbow

Size	a	b	Za	Zb	Order code
10mm x 3/8"	34	23	10	13	45590
10mm x 1/2"	34	23	10	11	45592
12mm x 3/8"	34	24	10	13	45594
12mm x 1/2"	34	25	10	11	45596
14mm x 1/2"	34	25	10	11	45600
15mm x 1/2"	34	25	10	11	45606
16mm x 1/2"	34	25	9	12	45608
16mm x 3/4"	39	32	16	14	45609
18mm x 1/2"	36	25	12	11	45614
18mm x 3/4"	40	33	16	18	45615
22mm x 3/4"	42	33	13	18	45620
28mm x 1"	49	37	17	21	45622

Suitable for:

T15 Backplate elbow

Size	a	b	c	Za	Zb	Order code
10mm x 1/2"	44	34	20	11	11	45630
12mm x 1/2"	45	34	20	11	11	45638
14mm x 1/2"	45	35	20	12	11	45640
15mm x 1/2"	45	35	20	11	11	45646
16mm x 1/2"	45	35	20	10	12	45648
18mm x 1/2"	45	34	20	13	11	45650
18mm x 3/4"	51	40	20	9	11	45652
22mm x 3/4"	54	40	21	18	12	45654

Suitable for:  Flow chart: Figure 00, page 00

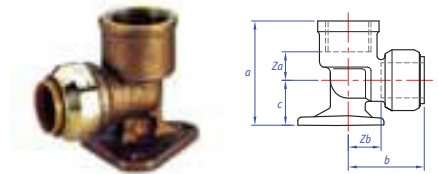

T21 Obtuse elbow

Size	a	Za	Order code
12mm	33	5	45531
14mm	33	5	45533
15mm	33	5	45535
16mm	33	5	45536
18mm	34	5	45537
22mm	41	6	45538
28mm	49	7	45539

Suitable for: 

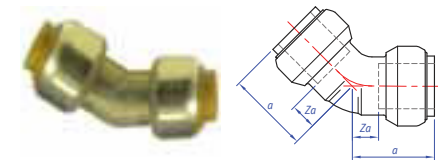

T21S Obtuse street elbow

Size	a	b	Za	Order code
12mm	33	36	5	45528
14mm	33	37	5	45529
15mm	33	37	5	45542
16mm	33	37	5	45543
18mm	34	38	5	45544
22mm	41	42	6	45545
28mm	49	48	7	45546

Suitable for: 

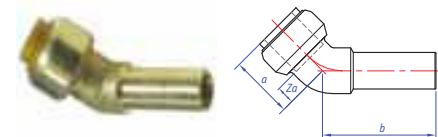

Demountable push-fit for copper and plastic

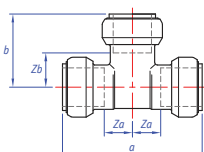

T24 Equal tee

Size	a	b	Za	Zb	Order code
10mm	59	30	6	6	45660
12mm	62	31	7	7	45662
14mm	65	33	8	9	45664
15mm	65	34	9	10	45666
16mm	68	34	10	10	45668
18mm	68	34	10	10	45670
20mm	80	41	14	12	45674
22mm	81	41	12	12	45676
28mm	97	49	16	15	45678

Suitable for:

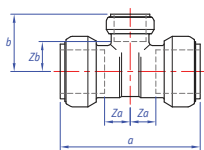

T25 Tee, reduced branch

Size	a	b	Za	Zb	Order code
12 x 12 x 10mm	60	32	7	7	45700
14 x 14 x 12mm	62	33	8	9	45710
15 x 15 x 10mm	59	32	6	8	45715
15 x 15 x 12mm	63	33	8	9	45717
16 x 16 x 12mm	66	33	8	9	45719
16 x 16 x 14mm	67	34	10	10	45722
18 x 18 x 14mm	67	35	10	11	45724
20 x 20 x 16mm	75	36	9	12	45726
22 x 22 x 10mm	70	38	6	14	45730
22 x 22 x 14mm	75	38	9	14	45736
22 x 22 x 15mm	75	38	9	14	45737
22 x 22 x 16mm	75	38	9	14	45739
22 x 22 x 18mm	78	36	10	12	45742
28 x 28 x 15mm	84	40	10	16	45744
28 x 28 x 18mm	87	39	10	15	45745
28 x 28 x 22mm	91	44	12	15	45746

Suitable for:

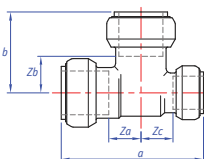

T26 Tee, one end reduced

Size	a	b	Za	Zb	Zc	Order code
15 x 10 x 15mm	65	34	9	10	9	45780
22 x 15 x 22mm	78	41	9	13	17	45786
22 x 18 x 22mm	78	41	9	13	17	45788
28 x 15 x 28mm	88	48	12	16	25	45790
28 x 18 x 28mm	88	48	11	16	24	45792
28 x 22 x 28mm	92	48	11	15	20	45793

Suitable for:

T27 Tee, one end and branch reduced

Size	<i>a</i>	<i>b</i>	<i>Za</i>	<i>Zb</i>	<i>Zc</i>	Order code
15 x 10 x 10mm	63	32	8	9	8	45810
15 x 12 x 12mm	62	33	9	9	7	45812
16 x 14 x 14mm	66	33	10	9	9	45815
22 x 18 x 18mm	71	36	9	12	11	45819
22 x 15 x 15mm	73	36	9	13	10	45820
28 x 18 x 18mm	80	41	10	17	10	45821
28 x 22 x 22mm	89	44	15	16	15	45822

Suitable for: 

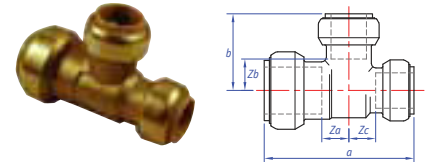

T30 Female branch tee

Size	<i>a</i>	<i>b</i>	<i>Za</i>	<i>Zb</i>	Order code
12 x 12mm x 1/2"	69	24	11	8	45823
15 x 15mm x 1/2"	69	25	11	12	45840
16 x 16mm x 1/2"	71	25	12	13	45825
22 x 22mm x 1/2"	78	27	10	14	45845
22 x 22mm x 3/4"	78	30	13	12	45846

Suitable for: 

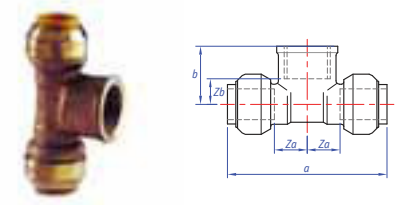

T61 Stop end

Size	<i>a</i>	Order code
10mm	24	45860
12mm	24	45862
14mm	24	45864
15mm	24	45866
16mm	24	45868
18mm	24	45870
20mm	29	45872
22mm	29	45874
28mm	32	45876

Suitable for: 

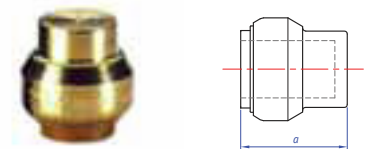

Demountable push-fit for copper and plastic

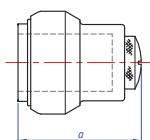

T61RV Air release stop end

Size	a	Order code
10mm	24	45890
12mm	24	45891
15mm	24	45892
18mm	24	45893
22mm	29	45894
28mm	32	45895

Suitable for:

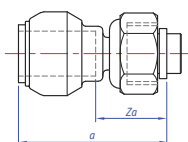

T62 Tap connector

Size	a	Za	Order code
10mm x 1/2"	40	16	45900
15mm x 1/2"	43	19	45902
15mm x 3/4"	42	18	45171
22mm x 3/4"	52	24	45903

Suitable for:

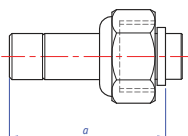

T62S Tap connector

Size	a	Order code
15mm x 1/2"	39	45910
15mm x 3/4"	45	45912
22mm x 3/4"	49	45914

Suitable for:

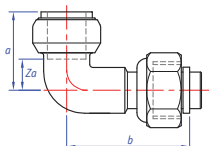

T63 Bent tap connector

Size	a	b	Za	Order code
10mm x 1/2"	34	42	11	45920
15mm x 1/2"	33	45	9	45922
22mm x 3/4"	40	47	12	45924

Suitable for:

T68FF Flat faced union adaptor

Size	a	Za	Order code
15mm x 3/4"	34	11	40759

Suitable for:

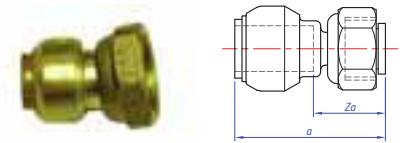

Classic Flexifit

TF90 Flexible connector

Size	a	Order code
15mm	300	45983
22mm	400	45984

Suitable for:

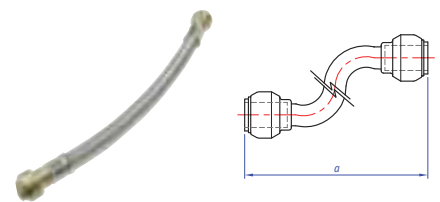

TF92 Flexible tap connector

Size	a	Order code
15mm x 1/2"	300	45985
22mm x 3/4"	400	45986

Suitable for:

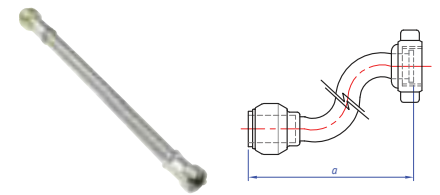

Classic push-fit manifolds

TM80 Manifold

Size	a	b	c	Za	Zb	Order code
22 x 22 x 10mm	75	37	38	47	12	45940

Suitable for:

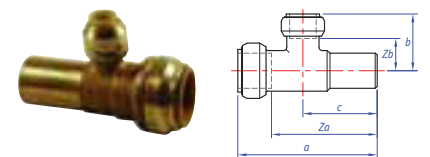

TM81 Manifold

Size	a	b	c	Za	Zb	Order code
22 x 22 x 10 x 10mm	75	37	38	47	12	45942

Suitable for:

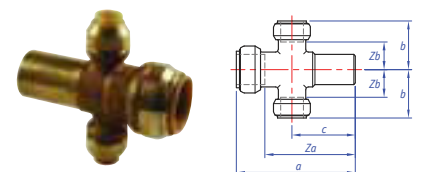

Enhanced performance demountable push-fit fittings

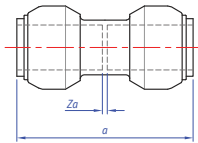

TX1 Straight coupling

Size	a	Za	Order code
15mm	49	1	65114
22mm	59	1	65121
28mm	65	1	65123
35mm	115	1	45126
42mm	125	1	45128
54mm	139	1	45130

Suitable for:

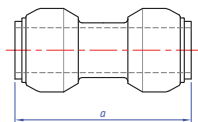

TX1 Slip straight coupling, slip pattern

Size	a	Order code
15mm	49	65141
22mm	59	65143
28mm	65	65144
35mm	115	45145
42mm	125	45146
54mm	139	45147

Suitable for:

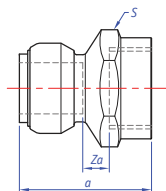

TX2 Straight female connector

Size	a	Za	S	Order code
15mm x 1/2"	40	3	25	65206
22mm x 3/4"	47	3	32	65222
22mm x 1"	49	2	38	65223
28mm x 1"	53	1	37	65225
35mm x 1 1/4"	84	5	48	45230
42mm x 1 1/2"	89	4	54	45232
54mm x 2"	101	4	66	45234

Suitable for:

Enhanced performance demountable push-fit fittings

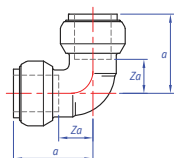

TX12 Elbow

Size	a	Za	Order code
15mm	33	9	65516
22mm	40	12	65524
28mm	49	17	65526
35mm	76	19	45530
42mm	85	23	45532
54mm	98	29	45534

Suitable for:

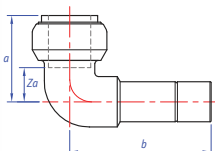

TX12S Street elbow

Size	a	b	Za	Order code
15mm	33	44	9	65496
22mm	41	48	12	65500
28mm	49	57	17	65502

Suitable for:

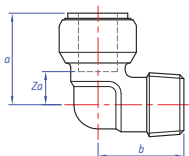

TX13 Male elbow

Size	a	b	Za	Order code
15mm x 1/2"	29	33	9	65561
22mm x 3/4"	34	41	12	65576
28mm x 1"	42	49	17	65578

Suitable for:

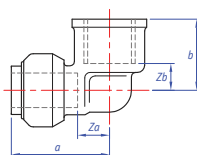

TX14 Female elbow

Size	a	b	Za	Zb	Order code
15mm x 1/2"	34	26	10	11	65606
22mm x 3/4"	42	25	13	18	65620
28mm x 1"	49	37	17	21	65622

Suitable for:

TX15 Backplate elbow

Size	a	b	c	Za	Zb	Order code
15mm x 1/2"	45	35	20	11	11	65646

Suitable for:

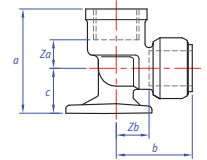

TX21 Obtuse elbow

Size	a	Za	Order code
15mm	33	9	65535
22mm	41	12	65538
28mm	49	17	65539
35mm	76	19	45540
42mm	85	23	45541
54mm	98	29	45558

Suitable for:

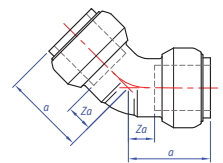

TX21S Obtuse street elbow

Size	a	b	Za	Order code
15mm	33	37	9	65542
22mm	41	42	12	65545
28mm	49	48	17	65546
35mm	56	94	10	45547
42mm	75	106	13	45548
54mm	83	114	14	45549

Suitable for:

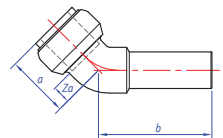

TX24 Equal tee

Size	a	b	Za	Zb	Order code
15mm	65	34	9	10	65666
22mm	81	41	12	12	65676
28mm	97	49	16	15	65678
35mm	152	76	20	20	45680
42mm	170	85	23	23	45682
54mm	196	98	29	29	45684

Suitable for:

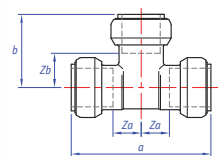

Enhanced performance demountable push-fit fittings

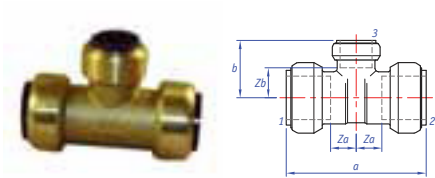

TX25 Tee, reduced branch

Size (1 x 2 x 3)	a	b	Za	Zb	Order code
22 x 22 x 15mm	75	38	9	14	65737
28 x 28 x 15mm	84	40	10	16	65744
28 x 28 x 22mm	91	44	12	15	65746
35 x 35 x 15mm	135	67	11	44	45750
35 x 35 x 22mm	148	74	17	45	45752
35 x 35 x 28mm	148	78	17	46	45753
42 x 42 x 15mm	159	82	18	58	45754
42 x 42 x 22mm	159	76	18	47	45756
42 x 42 x 28mm	159	81	18	49	45758
54 x 54 x 15mm	175	89	19	65	45760
54 x 54 x 22mm	175	84	19	55	45762
54 x 54 x 28mm	175	87	19	55	45764
54 x 54 x 35mm	177	86	21	29	45765

Suitable for:

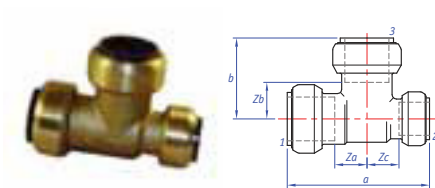

TX26 Tee, one end reduced

Size (1 x 2 x 3)	a	b	Za	Zb	Zc	Order code
22 x 15 x 22mm	78	41	9	13	17	65786
28 x 15 x 28mm	88	48	12	16	25	65790
28 x 22 x 28mm	92	48	11	15	20	65793

Suitable for:

TX27 Tee, one end and branch reduced

Size (1 x 2 x 3)	a	b	Za	Zb	Zc	Order code
22 x 15 x 15mm	73	36	9	13	10	65820
28 x 22 x 22mm	89	44	15	16	15	65822

Suitable for:

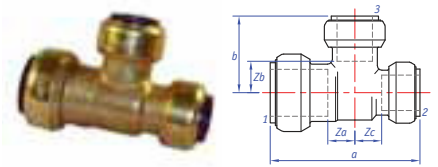

TX30 Female branch tee

Size	a	b	Za	Zb	Order code
15 x 15mm x 1/2"	69	25	11	12	65840
22 x 22mm x 1/2"	78	27	10	14	65845
35 x 35mm x 1/2"	135	38	11	21	65848
42 x 42mm x 1/2"	147	41	12	25	65850

Suitable for:

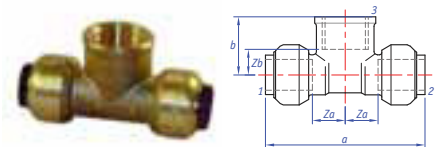

TX61 Stop end

Size	a	Order code
15mm	24	65866
22mm	29	65874
28mm	32	65876
35mm	57	45878
42mm	62	45880
54mm	69	45882

Suitable for:

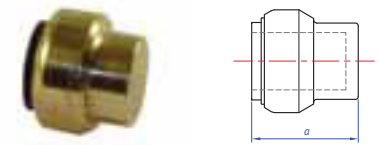

Enhanced performance demountable push-fit fittings

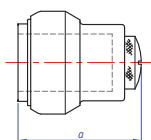

TX61RV Air release stop end

Size	a	Order code
15mm	24	65892
22mm	29	65894
28mm	32	65895

Suitable for:

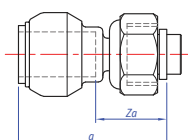

TX62 Tap connector

Size	a	Za	Order code
15mm x 1/2"	43	19	65902
15mm x 3/4"	42	18	65171
22mm x 3/4"	52	24	65903

Suitable for:

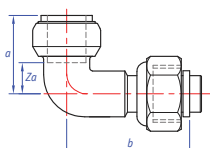

TX63 Bent tap connector

Size	a	b	Za	Order code
15mm x 1/2"	33	45	9	65922
22mm x 3/4"	40	47	12	65924

Suitable for:

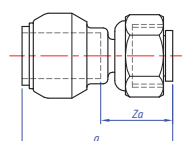

TX68FF Flat faced union adaptor

Size	a	Za	Order code
15mm x 3/4"	34	11	65759

Suitable for:

TX68S Cylinder union

Size	<i>a</i>	Order code
22mm x 1"	48	65930

Suitable for: 

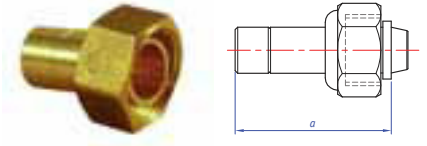
**Pro Flexifit****TXF90 Flexible connector**

Size	<i>a</i>	Order code
15mm	300	65983
22mm	400	65984

Suitable for: 

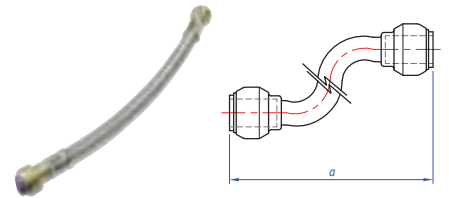
**TXF92 Flexible tap connector**

Size	<i>a</i>	Order code
15mm x 1/2"	300	65985
22mm x 3/4"	400	65986

Suitable for: 

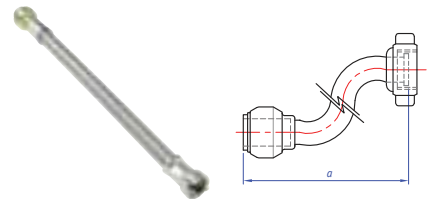

TS3 Tapered male connector

Size	a	Za	S	Order code
15mm x 1/2"	43	19	24	25267
18mm x 1/2"	43	19	24	25286
18mm x 3/4"	44	20	28	25288
22mm x 3/4"	46	17	28	25292
28mm x 1"	54	20	36	25296
35mm x 1 1/4"	83	26	43	25310
42mm x 1 1/2"	88	26	50	25312
54mm x 2"	100	31	61	25314

Suitable for: 

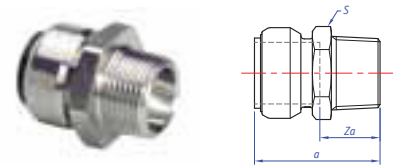

TS6 Reducer

Size	a	Za	Order code
18 x 15mm	46	22	25424
22 x 15mm	52	30	25426
22 x 18mm	52	28	25430
28 x 15mm	55	31	25435
28 x 18mm	55	31	25437
28 x 22mm	56	27	25438
35 x 22mm	83	54	25452
35 x 28mm	87	53	25454
42 x 22mm	87	58	25458
42 x 28mm	92	58	25460
42 x 35mm	116	59	25462
54 x 35mm	124	67	25470
54 x 42mm	129	67	25472

Suitable for: 

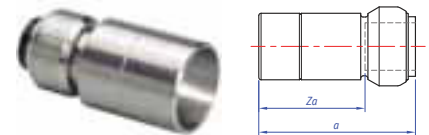

TS12 Elbow

Size	a	Za	Order code
15mm	33	9	25516
18mm	35	11	25520
22mm	41	12	25524
28mm	49	15	25528
35mm	76	19	25530
42mm	85	23	25532
54mm	98	29	25534

Suitable for: 

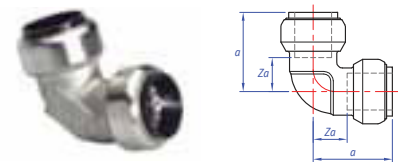

TS61 Stop end

Size	a	Order code
15mm	24	25866
18mm	24	25870
22mm	29	25874
28mm	34	25876
35mm	57	25878
42mm	62	25880
54mm	69	25882

Suitable for: 

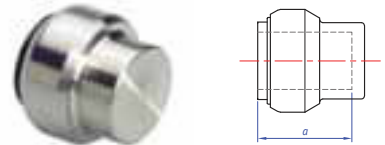

TS62 Tap connector

Size	a	Za	Order code
15mm x 1/2"	43	19	25902
22mm x 3/4"	52	24	25903

Suitable for: 

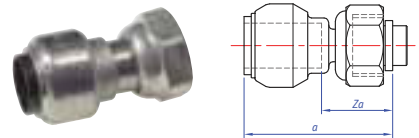

Carbon steel push-fit fittings

System tubes



SC640 Carbon steel system tube

Size	Finish	Length	Order code	Length	Order code
15mm x 1.2mm*	Galvanised steel	6m	45080	3m	25080
18mm x 1.2mm*	Galvanised steel	6m	45081	3m	25081
22mm x 1.5mm*	Galvanised steel	6m	45082	3m	25082
28mm x 1.5mm*	Galvanised steel	6m	45083	3m	25083
35mm x 1.5mm*	Galvanised steel	6m	45084	3m	25084
42mm x 1.5mm*	Galvanised steel	6m	45085	3m	25085
54mm x 1.5mm*	Galvanised steel	6m	45086	3m	25086

Suitable for:



SC660 Plastic coated carbon steel system tube

Size	Finish	Order code
15mm x 2.2mm* x 6m	Galvanised steel	25060
18mm x 2.2mm* x 6m	Galvanised steel	25061
22mm x 2.5mm* x 6m	Galvanised steel	25062
28mm x 2.5mm* x 6m	Galvanised steel	25063
35mm x 2.5mm* x 6m	Galvanised steel	25064
42mm x 2.5mm* x 6m	Galvanised steel	25065
54mm x 2.5mm* x 6m	Galvanised steel	25066

Suitable for:

Advance push-fit fittings

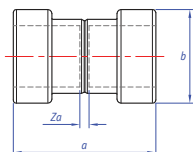

TA1 Straight coupling

Size	a	b	Za	Order code
15mm	40	23	3	76000
18mm	42	26	4	76001
22mm	42	31	4	76002
28mm	46	38	6	76003
35mm	67	46	7	76004
42mm	74	55	7	76005
54mm	78	67	7	76006

Suitable for:

*Supplied and priced from the XPress Stainless range.

Carbon steel push-fit fittings

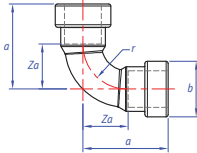

TA12 Elbow

Size	a	b	Za	r	Order code
15mm	35	23	17	18	76033
18mm	40	26	21	22	76034
22mm	46	31	26	27	76035
28mm	55	38	35	34	76036
35mm	73	46	42	42	76037
42mm	83	55	51	50	76038
54mm	101	68	64	65	76039

Suitable for:

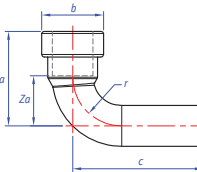

TA12S Street elbow

Size	a	b	c	Za	r	Order code
15mm	35	23	52	17	18	76040
18mm	40	26	52	21	22	76041
22mm	46	31	58	26	27	76042
28mm	55	38	68	35	34	76043
35mm	73	46	93	42	42	76044
42mm	83	55	105	51	50	76045
54mm	101	68	117	65	65	76046

Suitable for:

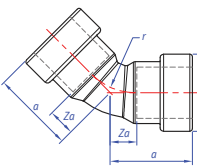

TA21 Obtuse elbow

Size	a	b	Za	r	Order code
15mm	25	23	7	18	76047
18mm	27	26	9	22	76048
22mm	30	31	11	27	76049
28mm	35	38	15	34	76050
35mm	48	46	17	42	76051
42mm	54	55	21	50	76052
54mm	63	68	26	65	76053

Suitable for:

Carbon steel push-fit fittings

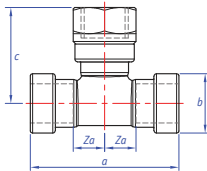

TA30 Female branch tee

Size	a	b	c	Za	Order code
15 x 15mm x 1/2"	59	23	47	12	76085
18 x 18mm x 1/2"	63	26	45	14	76086
22 x 22mm x 1/2"	67	31	55	16	76087
28 x 28mm x 1/2"	71	38	56	16	76088
35 x 35mm x 1/2"	90	47	70	14	76089
42 x 42mm x 1/2"	99	55	64	18	76090
54 x 54mm x 1/2"	106	68	70	16	76091

Suitable for:

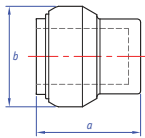

TS61 Stop end

Size	a	Order code
15mm*	24	25866
18mm*	24	25870
22mm*	29	25874
28mm*	34	25876
35mm*	57	25878
42mm*	62	25880
54mm*	69	25882

Suitable for:

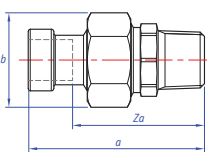

TA69 Straight male union connector

Size	a	b	Za	Order code
15mm x 1/2"	72	32	53	76092
18mm x 1/2"	72	32	53	76094
22mm x 3/4"	78	38	59	76097
28mm x 1"	86	48	65	76099
35mm x 1 1/4"	97	53	66	76100
42mm x 1 1/2"	104	67	71	76101
54mm x 2"	124	67	88	76102

Suitable for:

*Supplied and priced from the Tectite 316 range.

Tectite accessories

DT Disconnecting tool

Size	Order code
10mm	45970
12mm	45971
14mm	45972
15mm	45973
16mm	45974
18mm	45975
22mm	45977
28mm	45978



DC Disconnecting clip

Size	Order code
10mm	46100
12mm	46101
14mm	46102
15mm	46103
16mm	46104
18mm	46105
22mm	46107
28mm	46108



DTX Disconnecting tool

Size	Order code
35-54mm	46145



T66 PEX Liner

Size	Order code
10mm	60100
15mm	60103
22mm	60105
28mm	60106



T67 Copper liner

Size	Order code
10mm	60144



Accessories



T110 Deburring/scribe tool

Size	Order code
10-28mm	46132



T115 Tectite Sprint deburring/scribe tool

Size	Order code
10-28mm	75640



T120 Pipe clips - nail in

Size	Order code
10mm	60110
15mm	60111
22mm	60112
28mm	60113



T125 Bend former

Size	Order code
15mm	60130



T140 Pipe cutter-ratchet

Size	Order code
10-28mm	60120



TCX End cap

Size	Order code
35mm	46180
42mm	46181
54mm	46182

TDX Demounting end cap

Size	Order code
35mm	46146
42mm	46151
54mm	46156



TX100 Replacement 'O' ring

Size	Order code
35mm	46147
42mm	46148
54mm	46149



TX105 Replacement grab ring

Size	Order code
35mm	46135
42mm	46136
54mm	46137



TX106 Replacement grab ring for Tectite 316

Size	Order code
35mm	46183
42mm	46184
54mm	46185



S122 Tube preparation kit

Size	Order code
35-54mm	39233



S130 Silicone lubricant grease

Size	Order code
100g tub	39219



Quarter-turn ball valves and servicing valves

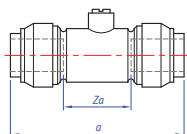

TX480 Servicing valve

Size	a	Za	Order code
15mm	69	21	65950

Suitable for: (A)

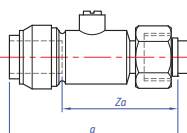

TX481 Servicing valve

Size	a	Za	Order code
10mm x 1/2"	74	50	45952
15mm x 1/2"	70	46	65954

Suitable for: (A)

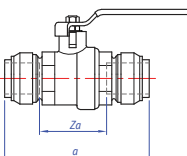

TX490L Quarter-turn ball valve

Size	a	Za	Order code
15mm	83	35	65962
22mm	94	36	65964

Suitable for: (A)

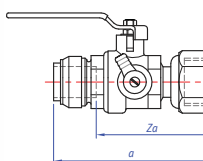

TX495 Quarter-turn ball valve

Size	a	Za	Order code
15mm x 3/4"	76	52	65960

Suitable for: (A)

TX496 Quarter-turn ball valve

Size	a	Za	Order code
15mm x 3/4"	76	52	65959

Suitable for: 

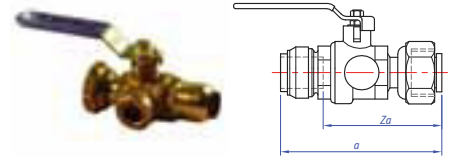

TX526S DZR draining tap

Size	a	b	c	S	Order code
15mm	74	35	56	8	65936

Suitable for: 

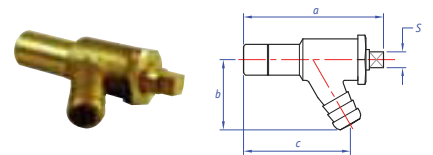

Tube compatibility

FITTING AND TUBE COMPATIBILITY						
Tube/pipe type	Standard	Tectite Sprint	Tectite Classic	Tectite Pro	Tectite 316	Tectite Advance
Copper tube	BS EN 1057	✓	✓	✓	✓	-
PB pipe (with liner)	BS 7291: Part 2	✓	✓	✓	-	-
PEX pipe (with liner)	BS 7291: Part 3	✓	✓	✓	-	-
Stainless steel tube	EN 10312	-	-	-	✓	-
Carbon steel tube	EN 10305-2	-	-	✓	✓	✓
Plastic coated carbon steel tube	EN 10305-2	-	-	-	-	✓

It is advisable to make copper to steel connections via gunmetal/copper alloy fittings.

Typical applications



- Hot and cold water services
- Heating and chilled water applications
- Low temperature hot water heating
- Pressurised, vented and unvented heating systems
- Non demountable



- Hot and cold water services
- Heating applications
- Low temperature hot water heating
- Pressurised, vented and unvented heating systems
- Demountable



- Hot and cold water services
- Heating and chilled water applications
- Low temperature hot water heating
- Pressurised, vented and unvented heating systems
- Potable water applications
- Demountable



- Where water quality and hygiene are issues
- Hot and cold water services
- Heating and chilled water applications
- Low temperature hot water heating
- Pressurised, vented and unvented heating systems
- Demountable



- Unvented closed circuit heating and chilled water applications (closed loop)
- Threaded steel system replacement
- Non demountable

RECOMMENDED APPLICATIONS						
Application	Tectite Sprint	Tectite Classic	Tectite Pro	Tectite 316	Tectite Advance	
Commercial mechanical services						
Chilled	✓	✗	✓	✗	✓	
Potable	✓	✗	✓	✓	✗	
Heating	✓	✗	✓	✗	✓	
Hot water services	✓	✗	✓	✓	✗	
Food	✗	✗	✗	✓	✗	
Brewery	✗	✗	✗	✓	✗	
Gas	✗	✗	✗	✗	✗	
Domestic						
Potable	✓	✓	✗	✓	✗	
Heating	✓	✓	✗	✓	✓	
Gas	✗	✗	✗	✗	✗	
Hot water services	✓	✓	✗	✗	✗	
Cold water services	✓	✓	✗	✗	✗	
Grey/rain water	✓	✓	✗	✗	✗	

Materials specification

Component					
Body	Copper or DZR brass	DZR brass or gunmetal	Stainless steel (316)	DZR brass or gunmetal	Carbon steel (zinc plated)
'O' ring	EPDM*	EPDM*	EPDM*	EPDM*	EPDM*
Alignment ring	Glass filled nylon 6	Glass filled Nylon 6	Glass filled Nylon 6	Glass filled Nylon 6	Glass filled Nylon 6
Cartridge/ Demounting ring	N/A	Acetal copolymer	Up to 28mm cartridge ring brass tin plated	Up to 28mm cartridge ring brass	N/A
Grab ring	Stainless steel	Stainless steel	Stainless steel	Stainless steel	Stainless steel
35-54mm End Cap	-	-	High performance nylon	High performance nylon	-
Shim	-	-	-	-	Mild steel (Zinc plated)

NB. The 'O' ring in all Tectite fittings is manufactured from Ethylene Propylene Diene Monomer (EPDM) and is supplied lubricated for easy tube insertion.
*Ethylene Propylene Diene Monomer

Manufacturing standards

Component	Standard	Summary					
Taper end thread	ISO 7/EN10226-1 (formerly BS 21/ISO 7)	Pipe-threads, where pressure-tight joints are made on the threads (metric dimensions)	✓	✓	✓	✓	✓
Parallel end thread	BS EN ISO 228:2003 (formerly BS 2779/ISO R228/1)	Pipe-threads, where pressure-tight joints are not made on the threads (metric dimensions)	✓	✓	✓	✓	✓

Connectors

Male connectors

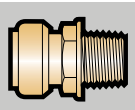

Tectite male connectors have either taper male BSP threads to ISO 7 (formerly BS 21) or parallel BSP threads to BS EN ISO 228:2003. Inert jointing compounds or PTFE tape should be applied to taper threads and good quality jointing washers should be used with parallel threaded fittings.

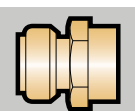

Female connectors

Tectite female threaded connectors have internal parallel threads to BS EN ISO 228:2003.

Working temperatures and pressure tables

The maximum temperature and pressure range in any system is dictated by the component with the lowest performance rating. Remember to pressure test all systems thoroughly after completion. Tectite installations may be tested to 1.5 times their normal working pressure at ambient temperature.

Achieving low temperatures

For products used in water systems, working temperatures of less than 4°C can only be achieved if antifreeze is added to the system.

Pressure Equipment Directive

Since 30th May 2002 most pressure equipment and assemblies on the market in the

United Kingdom have had to comply with the Pressure Equipment Directive (P.E.D.) 1999. Fittings are exempt from the P.E.D. unless they are incorporated into pressure equipment, meaning that all Tectite fittings are exempt. Tectite valves are also exempt. For a detailed explanation please visit: www.pegleryorkshire.co.uk/technical.cfm

Tectite fitting	Tube/pipe used with	Min. temperature		Max. temperature	
Classic	Copper	-24°C*	30°C	65°C	95°C
		16 bar	16 bar	10 bar	6 bar
Classic	PB or PEX	-20°C*	20°C	65°C	92°C
		12 bar	12 bar	6 bar	3 bar
Sprint	Copper	-24°C*	30°C	65°C	114°C
		20 bar	20 bar	16 bar	10 bar
Sprint	PB or PEX	-20°C*	20°C	65°C	92°C
		12 bar	12 bar	6 bar	3 bar
Pro up to 28mm	Copper	-24°C*	30°C	65°C	114°C
		20 bar	20 bar	16 bar	10 bar
Pro over 35mm	Copper	-24°C*	30°C	65°C	90°C
		16 bar	16 bar	10 bar	6 bar
316 up to 28mm	Stainless steel	-24°C	30°C	65°C	114°C
		20 bar	20 bar	16 bar	10 bar
316 over 35mm	Stainless steel	-24°C	30°C	65°C	90°C
		16 bar	16 bar	10 bar	6 bar
Advance	Carbon steel	-24°C	30°C	65°C	114°C
		20 bar	20 bar	16 bar	10 bar
Advance	Plastic coated carbon steel	-24°C	30°C	65°C	114°C
		20 bar	20 bar	16 bar	10 bar

*Female T, TX and TT fittings to be DENSO® wrapped to avoid failure.

All performance figures based on correct assembly of fittings and tube/pipe as detailed in installation instructions.

TECTITE CLASSIC & TECTITE PRO FLEXIBLE HOSE/TAP CONNECTORS:

Performance when correctly assembled with copper tube to BS EN 1057

Sizes	Min. temperature		Max. temperature	
15mm	-20°C	30°C	65°C	90°C
	16 bar	16 bar	10 bar	6 bar
22mm	-20°C	30°C	65°C	90°C
	10 bar	10 bar	10 bar	6 bar

TECTITE PRO SERVICING VALVES:

Performance when correctly assembled with copper tube to BS EN 1057 and carbon steel System tube

Outside diameter	Min. temperature		Max. temperature	
15-54mm	-15°C	30°C	65°C	90°C
	16 bar	16 bar	10 bar	6 bar

Equipotential bonding

All metallic pipework systems should comply with the equipotential bonding requirements of the current edition of the IEE electrical wiring regulations (BS 7671: 2001). After all plumbing work has been completed, always ensure guaranteed continuity checks are conducted by a qualified electrician in accordance with regulations.



Electrical continuity

Tectite Sprint	✓
Tectite Classic	✗
Tectite Pro	✓
Tectite 316	✓
Tectite Advance	✓

Copper tube

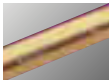

Compatible copper tube must meet the requirements

of BS EN 1057 for copper and copper alloy – seamless round copper tubes for water (and gas) in sanitary and heating applications.

BS EN 1057 includes specified temper conditions (material strength) expressed as an 'R' number. Quite simply, the higher the number, the harder the material. As a result, tube

diameter, wall thickness, length and the material temper must all be specified for full product designation.

All Tectite 316 fittings can be used with copper tube, although in humid conditions some staining of the tube may be witnessed (see page 57 Phenolic foam section for details on moisture-proof insulation).

Yorkex* copper System tube is manufactured to the same standards as above and offers the same features and benefits.

**Yorkex is a brand name of Yorkshire Copper Tube.*

COPPER TUBE BS EN 1057 COMPATIBILITY: Tectite Sprint, Tectite Classic and Tectite Pro fittings All tube tempers (R220, R250 and R290) are available in all the designated wall thicknesses

Outside diameter	Wall thickness							
	0.6mm	0.7mm	0.8mm	0.9mm	1.0mm	1.2mm	1.5mm	2.0mm
10mm	✓	✓	✓	–	✓	–	–	–
12mm	✓	–	✓	–	✓	–	–	–
15mm	–	✓	–	–	✓	–	–	–
22mm	–	–	–	✓	✓	✓	–	–
28mm	–	–	–	✓	✓	✓	✓	–
35mm	–	–	–	–	–	✓	✓	–
42mm	–	–	–	–	–	✓	✓	–
54mm	–	–	–	–	–	✓	–	✓



When Yorkex* copper tube is used with Tectite fittings as part of a complete system an enhanced guarantee of 30 years will apply.

Tectite fittings can also be used with copper tube to the above standards, in which case a 25 year guarantee will apply.

Tectite-PEX barrier pipe

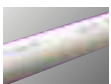

Tectite-PEX is a high-integrity cross-linked polyethylene barrier

pipe. Available in sizes from 10mm to 28mm in 3m and 6m straight lengths or 25m, 50m and 100m coils, it is suitable for use with Tectite Sprint and Tectite Classic fittings (use with T66 liners). You can use Tectite Sprint and Tectite Classic fittings on all PEX plastic pipes which meet BS 7291: Part 3 (use with appropriate manufacturers' liners). Tectite 316 fittings cannot be used with plastic pipes.

For the ultimate in convenience, our Tectite Sprint and Tectite Classic ranges of fittings can also be used with PB pipe that conforms to BS 7921: Part 2 (use with appropriate manufacturers' liners).

At the heart of Tectite-PEX is an EVOH (ethylene vinyl alcohol) resin oxygen barrier found centrally within the pipe wall. This barrier inhibits the ingress of oxygen – vital in central heating applications where permeation of oxygen into the system can cause radiator corrosion.

TECTITE-PEX BENDS	
Size	Maximum Radii
10mm	45mm using T120 clips
15mm	100mm using T120 clips, 90mm using T125 bend former brackets
22mm	175mm using T120 clips
28mm	300mm using T120 clips

Flexibility

Tectite-PEX is flexible enough to be cabled around obstructions and through joists with ease, saving on time and materials. The product's flexibility also allows it to absorb energy and so reduce noise from water hammer and thermal movement.

The pipe's low thermal conductivity means exposed pipework in central heating systems is cooler to the touch than other materials. It is resistant to limescale and all-but eliminates the threat of burst pipes in cold conditions.

Lightweight and convenient to handle and store, Tectite-PEX

can be painted with either emulsion or oil-based gloss paints (NOT cellulose paint). Care must be taken to ensure that no paint comes into contact with Tectite fittings.

Installation

When installing Tectite-PEX, always remember to observe minimum bend radii to avoid kinking of the pipe. The Tectite accessories range includes a bend former for tight bends.

Standards and approvals

Tectite PEX adheres to all major trade specifications as follows:

BS 7291 Specification for thermo-plastic pipes and associated

fittings for hot and cold water for domestic purposes and heating installations in buildings.

BS 7291: Part 1 General requirements.

BS 7291: Part 3 Specification for cross-linked polyethylene (PEX) pipes and associated fittings.



Licence No. KM 70057

Kitemark approved All Tectite PEX barrier pipe is Kitemark approved.

WRAS Tectite PEX complies with The Water Supply (Water Fittings) Regulations 1999.

DIN Tectite PEX barrier pipe fully meets the requirements of DIN 16892.

TECTITE-PEX BARRIER PIPE TOLERANCES				
Dimensions	Wall thickness			
	1.6mm	1.6mm	2.1mm	2.7mm
12mm ± 0.1mm	-0.1mm	–	–	–
15mm ± 0.1mm	–	-0.1+0.2mm	–	–
22mm ± 0.1mm	–	–	-0.1+0.2mm	–
28mm ± 0.1mm	–	–	–	-0.1+0.2mm



When Tectite-PEX barrier pipe is used with Tectite fittings as part of a complete system an enhanced 30 year guarantee will apply.

Tectite fittings can also be used with PEX barrier pipe to the above standards, in which case a 25 year guarantee will apply.

Push-fit solutions Tubes, pipe and their compatibilities

Stainless steel 316 System tube

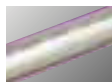

Specially designed to be used with Tectite 316 stainless steel fittings, 316 System tube is available in 6m straight lengths in sizes from 15mm to 54mm. The tube is manufactured from

BS 316 S31/DIN 1.4401 stainless steel strip conforming to BS10088 Part 2 and thanks to its thin-walled geometry, is stiff, lightweight and easy to handle.

Tectite 316 fittings are also compatible with stainless steel tubes to BS EN 10312 (encompassing the former BS 4127) and DVGW GW541.



When Tectite stainless steel System tube is used with Tectite fittings as part of a complete system an enhanced guarantee of 30 years will apply.

Tectite fittings can also be used with stainless steel tube to the above standards, in which case a 25 year guarantee will apply.

XPress galvanised carbon steel System tube and plastic coated carbon steel System tube

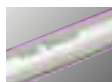

Carbon steel System tube from our XPress range is available in 3m and 6m straight lengths in sizes from 15mm to 108mm (54mm if plastic coated). Galvanised carbon steel System tube is manufactured in accordance with EN 10305-3 from material with a very low carbon content and has a thin walled profile resulting in a lightweight easier to handle product.

The galvanised coating (external only) has a minimum thickness of 7 microns and is thermally applied which provides a superior bond to the tube.

Tectite Advance can be used with our SC640 galvanised carbon steel System tube or our SC660 plastic coated carbon steel System tube.



When XPress galvanised carbon steel System tube or plastic carbon steel System tube is used with Tectite fittings as part of a complete system an enhanced 10 year guarantee will apply.

Tectite fittings can also be used with carbon steel tube and plastic coated carbon steel tube to the above standards, in which case a 5 year guarantee will apply.

STAINLESS STEEL 316 SYSTEM TUBE: Specification

Outside diameter	316 System tube	Wall thickness	
		EN 10312 Table 1 GW541 Table 2 (formerly BS 4127)	EN 10312 Table 2 GW541 Table 3
15mm	0.6mm	0.6mm	1.0mm
18mm	0.7mm	0.7mm	1.0mm
22mm	0.7mm	0.7mm	1.2mm
28mm	0.8mm	0.8mm	1.2mm
35mm	1.0mm	1.0mm	1.5mm
42mm	1.0mm	1.1mm	1.5mm
54mm	1.0mm	1.2mm	1.5mm

XPRESS GALVANISED CARBON STEEL TUBE: Specification

Outside diameter	Outside diameter including plastic coating	Wall thickness	
		Galvanised tube	Including plastic coating
15mm	17mm	1.2mm	2.2mm
18mm	19mm	1.2mm	2.2mm
22mm	24mm	1.5mm	2.5mm
28mm	30mm	1.5mm	2.5mm
35mm	37mm	1.5mm	2.5mm
42mm	44mm	1.5mm	2.5mm
54mm	56mm	1.5mm	2.5mm
67mm	-	1.5mm	-
76mm	-	2.0mm	-
89mm	-	2.0mm	-
108mm	-	2.0mm	-

CARBON STEEL SYSTEM TUBE: Bends

Size	Minimum Radii
15mm	30mm
18mm	36mm
22mm	44mm
28mm	56mm

In sizes up to 28mm Carbon steel System tube, is suitable for bending using proprietary bend formers.

The following are some of the specific design considerations it is important to take account of when designing and installing pipework systems containing Tectite fittings.

Thermal movement

Thermal movement is a major consideration when designing plumbing and heating systems. Pipework systems expand and contract with changes in temperature. If they are fixed too rigidly and their movement restricted, the systems will be

subject to stress which must be avoided. So it's important to take the effect of thermal movement into account when designing or installing a system.

It's especially important to avoid stress concentrations between fixed points typically

found at radiators, valves and other fittings. However, the ability of Tectite joints to rotate will accommodate movement within the system associated with expansion and contraction in certain design configurations.

The following tables show thermal expansion details for a range of tube/pipe lengths and temperature changes. For further calculations please refer to the Pegler Yorkshire System Design Document or visit the website.

TECTITE SPRINT, TECTITE CLASSIC AND TECTITE PRO: Copper tube expansion										
Temperature change	Tube length									
	3m	4m	5m	6m	7m	8m	9m	10m	12m	25m
10°C	0.5mm	0.7mm	0.9mm	1.0mm	1.2mm	1.4mm	1.5mm	1.7mm	2.0mm	4.3mm
20°C	1.0mm	1.4mm	1.7mm	2.0mm	2.4mm	2.7mm	3.0mm	3.4mm	4.0mm	8.5mm
30°C	1.5mm	2.0mm	2.6mm	3.1mm	3.6mm	4.1mm	4.6mm	5.1mm	6.1mm	13mm
40°C	2.0mm	2.7mm	3.4mm	4.1mm	4.8mm	5.4mm	6.1mm	6.8mm	8.2mm	17mm
50°C	2.6mm	3.4mm	4.3mm	5.1mm	6.0mm	6.8mm	7.7mm	8.5mm	10.2mm	21mm
60°C	3.1mm	4.1mm	5.1mm	6.1mm	7.1mm	8.2mm	9.2mm	10.2mm	12.2mm	26mm
70°C	3.6mm	4.8mm	6.0mm	7.1mm	8.3mm	9.5mm	10.7mm	11.9mm	14.3mm	30mm
80°C	4.1mm	5.4mm	6.8mm	8.2mm	9.5mm	10.9mm	12.2mm	13.6mm	16.3mm	34mm
90°C	4.6mm	6.1mm	7.7mm	9.2mm	10.7mm	12.2mm	13.8mm	15.3mm	18.4mm	38mm
100°C	5.1mm	6.8mm	8.5mm	10.2mm	11.9mm	13.6mm	15.3mm	17.0mm	20.4mm	43mm

TECTITE SPRINT, TECTITE CLASSIC AND TECTITE PRO: PEX barrier pipe expansion										
Upper working temperature	Lower working temperature									
	0°C	10°C	20°C	30°C	40°C	50°C	60°C	70°C	80°C	90°C
90°C	17.6mm	16.4mm	15.1mm	13.5mm	11.6mm	9.4mm	7.4mm	5.0mm	2.6mm	0.0mm
80°C	15.0mm	13.8mm	12.5mm	10.9mm	9.0mm	6.8mm	4.8mm	2.4mm	0.0mm	
70°C	12.6mm	11.4mm	10.1mm	8.5mm	6.6mm	4.0mm	2.4mm	0.0mm		
60°C	10.2mm	9.0mm	7.7mm	6.1mm	4.2mm	2.0mm	0.0mm			
50°C	8.2mm	7.0mm	5.7mm	4.1mm	2.2mm	0.0mm				
40°C	6.0mm	4.8mm	3.5mm	1.9mm	0.0mm					
30°C	4.1mm	2.9mm	1.6mm	0.0mm						
20°C	2.5mm	1.3mm	0.0mm							
10°C	1.2mm	0.0mm								
0°C	0.0mm									

TECTITE 316: Stainless steel System tube expansion										
Temperature change	Tube length									
	3m	4m	5m	6m	7m	8m	9m	10m	12m	25m
10°C	0.5mm	0.6mm	0.8mm	1.0mm	1.1mm	1.3mm	1.4mm	1.6mm	1.9mm	4.0mm
20°C	1.0mm	1.3mm	1.6mm	1.9mm	2.2mm	2.6mm	2.9mm	3.2mm	3.8mm	8.0mm
30°C	1.4mm	1.9mm	2.4mm	2.9mm	3.4mm	3.8mm	4.3mm	4.8mm	5.8mm	12.0mm
40°C	1.9mm	2.6mm	3.2mm	3.8mm	4.5mm	5.1mm	5.8mm	6.4mm	7.7mm	16.0mm
50°C	2.4mm	3.2mm	4.0mm	4.8mm	5.6mm	6.4mm	7.2mm	8.0mm	9.6mm	20.0mm
60°C	2.9mm	3.8mm	4.8mm	5.8mm	6.7mm	7.7mm	8.6mm	9.6mm	11.5mm	24.0mm
70°C	3.4mm	4.5mm	5.6mm	6.7mm	7.8mm	9.0mm	10.1mm	11.2mm	13.4mm	28.0mm
80°C	3.8mm	5.1mm	6.4mm	7.7mm	9.0mm	10.2mm	11.5mm	12.8mm	15.4mm	32.0mm
90°C	4.3mm	5.8mm	7.2mm	8.6mm	10.1mm	11.5mm	13.0mm	14.4mm	17.3mm	36.0mm
100°C	4.8mm	6.4mm	8.0mm	9.6mm	11.2mm	12.8mm	14.4mm	16.0mm	19.2mm	40.0mm

Push-fit solutions

System design considerations and tube expansion

TECTITE PRO*, TECTITE 316* AND TECTITE ADVANCE*:
Galvanised carbon steel System tube and plastic coated carbon steel System tube expansion

Temperature change	Tube length									
	3m	4m	5m	6m	7m	8m	9m	10m	12m	25m
10°C	0.4mm	0.5mm	0.6mm	0.7mm	0.8mm	1.0mm	1.1mm	1.2mm	1.4mm	3.0mm
20°C	0.7mm	1.0mm	1.2mm	1.4mm	1.7mm	1.9mm	2.2mm	2.4mm	2.9mm	6.0mm
30°C	1.1mm	1.4mm	1.8mm	2.2mm	2.5mm	2.9mm	3.2mm	3.6mm	4.3mm	9.0mm
40°C	1.4mm	1.9mm	2.4mm	2.9mm	3.4mm	3.8mm	4.3mm	4.8mm	5.8mm	12.0mm
50°C	1.8mm	2.4mm	3.0mm	3.6mm	4.2mm	4.8mm	5.4mm	6.0mm	7.2mm	15.0mm
60°C	2.2mm	2.9mm	3.6mm	4.3mm	5.0mm	5.8mm	6.5mm	7.2mm	8.6mm	18.0mm
70°C	2.5mm	3.4mm	4.2mm	5.0mm	5.9mm	6.7mm	7.6mm	8.4mm	10.1mm	21.0mm
80°C	2.9mm	3.8mm	4.8mm	5.8mm	6.7mm	7.7mm	8.6mm	9.6mm	11.5mm	24.0mm
90°C	3.2mm	4.3mm	5.4mm	6.5mm	7.6mm	8.6mm	9.7mm	10.8mm	13.0mm	27.0mm
100°C	3.6mm	4.8mm	6.0mm	7.2mm	8.4mm	9.6mm	10.8mm	12.0mm	14.4mm	30.0mm

*Closed circuit systems only.

Correct anchoring

Always ensure the spur used to anchor the branch of a tee or connecting a radiator is long enough to allow normal thermal movement. Failure to observe this simple rule can lead to a failure. Incorporating expansion loops or bellows devices into the system can help guard against such problems, whilst a horseshoe link or offset (see diagrams) is an ideal way to counteract continual thermal cycling.

Techniques for expansion stress relief



Horseshoe expansion link

Offset

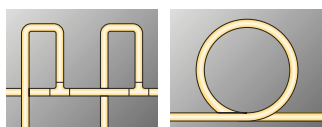

Crossover tee arrangement expansion loop

Suitable for 10mm tube only expansion loop

Thermal expansion

Never use so-called 'cold draw techniques' when designing expansion joints into a system containing any Tectite push-fit fittings. These techniques may compromise the integrity of the surrounding joints.

Design considerations

Some contracts may still require that proprietary chemicals are used to cleanse and flush pipework before full commissioning. Tectite is compatible with a wide selection of products, to find out more contact us.

Pipe restraint

In any installation, the system should be supported to ensure the minimum stress is imposed on the tube/pipe and joints. For the maximum spacing of supporting brackets for internal installations, please see the tables (right).

Insulation

For all Tectite Systems, we recommend you adhere to the insulation requirements as specified in BS 5970. These requirements are equally applicable to plastic pipe and stainless steel tube.

Maximum spacing of support brackets for internal fixing of copper tube

Copper tube to BS EN 1057	Horizontal run spacing		Vertical run spacing	
	R220	R250/R290	R220	R250/R290
10mm	1200mm	800mm	1600mm	1200mm
12mm	1500mm	1000mm	2000mm	1500mm
15mm	1800mm	1200mm	2400mm	1800mm
22mm	2400mm	1800mm	3000mm	2400mm
28mm	2400mm	1800mm	3000mm	2400mm
35mm	2700mm	2400mm	3000mm	3000mm
42mm	3000mm	2400mm	3600mm	3000mm
54mm	3000mm	2700mm	3600mm	3000mm

Maximum spacing of support brackets for internal fixing of Tectite-PEX Barrier Pipe

Size	Horizontal run spacing			Vertical run spacing		
	Average service temp.			Average service temp.		
	20°C	60°C	80°C	20°C	60°C	80°C
10mm	500mm	400mm	300mm	800mm	600mm	500mm
15mm	500mm	400mm	300mm	800mm	600mm	500mm
22mm	800mm	600mm	500mm	1200mm	1000mm	800mm
28mm	800mm	600mm	500mm	1200mm	1000mm	800mm

Maximum spacing of support brackets for internal fixing of 316 System tube, BS EN 10312 and GW541 stainless steel tube and carbon steel System tube

Size	Horizontal run spacing		Vertical run spacing	
15mm	1200mm		1800mm	
18mm	1500mm		2100mm	
22mm	1800mm		2400mm	
28mm	1800mm		2400mm	
35mm	2400mm		3000mm	
42mm	2400mm		3000mm	
54mm	2700mm		3000mm	

Phenolic foam

When using rigid phenolic foam (or other thermal insulation) to lag pipework, always remember to refer to the lagging manufacturer's fixing instructions. To avoid the risk of external corrosion of copper pipework lagged with this foam, it is recommended that such insulation products be installed with a moisture barrier. Materials like Densopaste or a plastics covering applied by the tube manufacturer both provide an appropriate barrier between the outer surface of the tube or fitting and the foam.

Some manufacturers of this type of lagging supply their products with an internal, factory-applied sodium silicate or polyethylene barrier to prevent external corrosion problems. However, if you do need to add a barrier product, we recommend that all Tectite fittings are fully installed and pressure tested before these are applied and that they are completely coated.

Covered pipework

Making provision for thermal movement is vital where pipework of any material is installed under screed, plaster or passes through brick or blockwork. The preferred practice is to: pass tubes and pipes through sleeves or conduits or to lay them in ducts surrounded by loose, non-rigid material such as vermiculite or glass wool. For further information, consult the publication BS 6700:1997 Water Services in Buildings.

Local Water Authority

It's wise to consult the local water authority when it comes to pipework accessibility.

Tube bending

Portable bending machines are ideal for copper tubes up to 28mm. Most machines bend the tube between matched formers and back guides that support the outside diameter (OD) of the tube. This eliminates the risk of the tube wall collapsing.

The point at which the bending pressure is exerted must be maintained at the correct distance in front of the former's point of support. It's also important to keep formers and guides well lubricated. Bending tubes correctly will avoid any wrinkling and flattening that can affect flow conditions.

Using adjustable bending machines (which allow the pressure on the back guide to be adjusted) will ensure perfect bends every time so long as the root (inside) bending radius is at least 3 times the outside diameter of the tube.

Pipework clearance

When designing a Tectite System, please take care to ensure all joints can be made and demounted easily. Observe minimum gaps and insertion distances to ensure sufficient access for a demounting clip/tool, where applicable (see fitting spacing tables).

Sizes	Min. gap between fittings	Min. tube projection
10mm	5mm	20mm
15mm	5mm	21mm
22mm	5mm	23mm
28mm	5mm	25mm

Sizes	Min. gap between fittings	Min. tube projection
10mm	10mm	40mm
12mm	10mm	40mm
15mm	10mm	40mm
22mm	10mm	40mm
28mm	10mm	50mm
35mm	50mm	100mm
42mm	50mm	100mm
54mm	50mm	100mm

Spacing

Fitting spacing

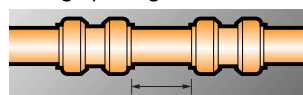

Sufficient space must be left between fittings to allow room for dis-assembly tools to operate. See adjacent table for fitting spacing.

Minimum projection

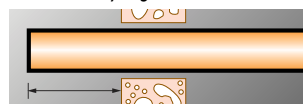

Similar consideration should be given to the distance pipe stubs project through walls or bulkheads. Refer to table.

Good practice

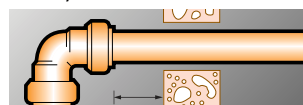

Projection distances shown in the table also ensure that the subsequent installation will be a convenient distance from the wall.

Push-fit solutions Installation instructions 10mm to 28mm sizes

The Tectite jointing system has been designed with easy, efficient installation in mind.

Guide to installation

The jointing procedures are almost identical for every type of Tectite fitting and compatible tube material. Where there are variations (such as inserting a liner into a PEX pipe) these are shown on the following pages and in the fitting instructions. To ensure the fittings stay clean and the 'O' ring is protected from damage, never remove the fitting from its packaging until immediately prior to installation.





The tube/pipe can be fully inserted by hand. A damaged tube/pipe end will require excessive force to be used. If this is the case you should check the tube/pipe is round and deburred before continuing. Tectite fittings with plain male ends must not be used directly with capillary fittings, since heating will damage the non-metallic parts. Neither should plain ends on capillary fittings be used with Tectite.

Heat should not be applied to Tectite fittings, directly or indirectly. They should be disconnected (where applicable) to avoid any possible damage to non-metallic parts if they are to be used on a system in conjunction with capillary fittings. Similarly, reconnection must not be considered until the heated tubes have been allowed to cool and have been flushed to remove any flux residues. Use pipe clips to secure finished installations and prevent vibration or movement.

Painting

Fittings can be painted with water-based paints. Oil-based or aggressive solvent paint should be avoided.

Socket depths

Socket depths			
	Size	Socket depth	
	10mm	15mm	
	15mm	16mm	
	22mm	18mm	
	28mm	20mm	
	10-18mm	23mm	
	22mm	27mm	
	28mm	31mm	
	10-18mm	23mm	
	22mm	27mm	
	28mm	31mm	
	35mm	57mm	
	42mm	62mm	
	54mm	68mm	
		15mm	18mm
		18mm	18mm
22mm		18mm	
28mm		20mm	
35mm		31mm	
42mm		32mm	
54mm	37mm		

Boiler connection

Tectite-PEX barrier pipe should not be joined directly to a boiler or other similar heat source. Connection should be via a piece of copper tube a minimum of 1m long.

Preparation

New tube ends should have any tape, labels or residual adhesive removed, taking care not to damage the tube in the process. Check the tube is round, clean and free from burrs and scores. If necessary, trim and prepare as below.

We recommend the use of a good quality tube cutter with a sharp

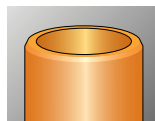

Tube cutters

For cutting PEX pipe we recommend the use of good quality pipe shears with a sharp blade. Clean, square cut pipe ends should have the pipe manufacturer's liners fitted.

Ensure the tube is cut square and all burrs and sharp edges are

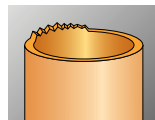

Remove burrs

removed and is chamfered as shown in the illustration. Having deburred as above you will be left with a 1mm chamfer on the outside of the tube as indicated in the diagram. Wipe clean the tube end to remove all swarf and debris.

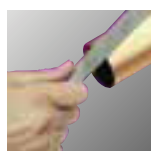
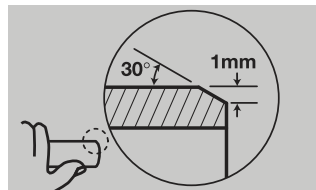

If a deburrer is not available, a fine file should be used to prepare the tube end.

Copper, chrome plated copper, stainless steel System and carbon steel System tubes

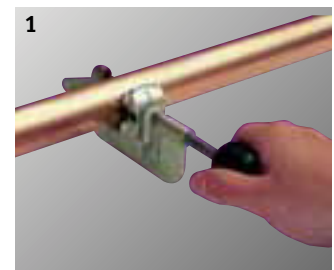

1. Select the correct size of tube and fitting for the job. Ensure both are clean, in good condition and free from damage, scores and imperfections. Do not use any additional lubricant or sealing compounds. Cut the tube square using a rotary tube cutter wherever possible. Take care to ensure that the tube end is deburred and chamfered. If the tube is oval or damaged, use a re-rounding tool.



2. Remove any burrs or sharp edges from the external tube end using either the T110 (Tectite Classic and Tectite Pro) or the T115 (Tectite Sprint and Tectite Advance) 3-in-1 Tectite deburring, scribe tool and socket depth marker or the S120 deburring tool from the

XPress accessories range. Also, ensure the internal bore is deburred. For deburring stainless steel tube ends a fine toothed file should be used.



Then wipe clean the tube end to remove all swarf and debris – this helps to avoid damage to the 'O' ring when inserting the tube.



An alternative method of preparing copper tube ends 35-54mm before inserting into the fitting, is to use the appropriately-sized S122 percussion deburrer (not for carbon steel tube) featured in the XPress accessories range. Place the cup of the deburrer onto the end of the tube and strike it with a sharp blow from a copper-faced hammer. As well as removing burrs and sharp edges, this tool also creates a slight taper that aids insertion into the fitting. If 10mm R220 annealed copper tube is being used, ensure a T67 support liner is fully inserted into the tube.

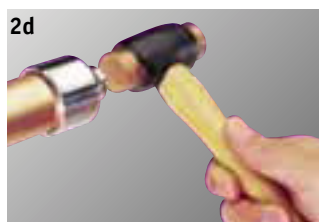

3. To make a perfect joint, the tube must be fully inserted in the fitting until it meets the tube stop. To confirm that this is the case, mark the socket depth on the tube or pipe using the T110/T115 socket depth marker (Tectite Classic, Tectite Pro & Tectite 316) or a tape measure and a marker/pencil. For the socket depth of each size of fitting, see tables.



4. When jointing chrome-plated copper tube with Tectite Classic, Tectite Pro and Sprint fittings, scribe the tube using the T110/T115 (Sprint) scribing tool to ensure positive grab ring location. This helps to accommodate any variance in chrome plate thickness. Note: The scribing function is not suitable for stainless steel tube.



Proceed to jointing (see next page).

PB and PEX pipe Plastic coated carbon steel System tube



1. Select the correct size of pipe and fitting for the job. Ensure both are clean, in good condition and free from damage, scores and imperfections. Do not use any additional lubricant or sealing compounds. Cut the pipe square using good quality plastic pipe shears with a sharp blade.

2. Where Tectite-PEX barrier pipe is used, remove the label from the pipe end. If the pipe has been used on a previous installation cut the tube back to behind the teeth marks, ensuring there are no score marks on the pipe. Also ensure the correct pipe support liner from the pipe manufacturer is fully inserted into the pipe (T66 for Tectite flex).



Proceed to jointing (see next page).

1. Select the correct size of tube and fitting for the job. Ensure both are clean, in good condition and free from damage, scores and imperfections. Do not use any additional lubricant or sealing compounds. Cut the tube square using a rotary tube cutter wherever possible.



2. The plastic coating must be removed to the socket depth of the fitting using the S115 stripping tool from the XPress accessories range. Select the correct sized tool, fully insert the tube and twist the tool until the excess of plastic is completely detached.

3. Remove any burrs or sharp edges from the external tube end using an S120 deburring tool from the XPress accessories range. Also deburr the internal bore. If using plastic coated tube, the use of the S115 tool (as point 2), will deburr the inside of 15mm to 28mm tube. The same tool will also deburr the outside of plastic coated tube – insert the tube into the opposite end of the tool and twist.

Push-fit solutions

Installation instructions

10mm to 28mm sizes

Joining

1. To make a perfect joint, the tube or pipe must be fully inserted in the fitting until it meets the tube stop. To confirm that this is the case, mark the socket depth on the tube or pipe using the appropriate socket depth marker or a tape measure and a marker/pencil. For the socket depth of each size of fitting, see tables on page 58.

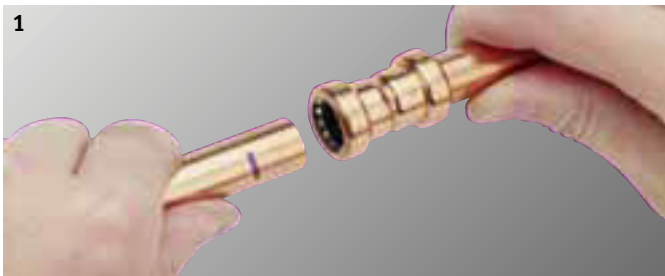

2. Inspect the fitting ensuring that the grab rings/'O'-rings have not been contaminated with grit or debris. Insert the tube/pipe into the mouth of the fitting to rest against the grab ring.

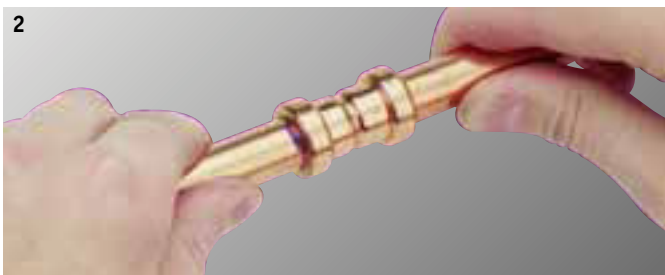

3. Push the tube firmly with a slight twisting action until it reaches the tube stop with a positive "click".

4. Ensure the depth insertion mark corresponds with the mouth of the fitting and then pull firmly on the tube to ensure the fitting is secure.

NOTE: We recommend all systems are thoroughly pressure tested to 1.5 times working pressure before the hand-over to the customer.



NOTE: Tectite Sprint and Tectite Advance fittings must not be used with the male ended fittings from other Tectite ranges (except T526S). Other third party male ended products should not be used with any Tectite fittings.

Do not use Tectite fittings on gas services.

Tectite Classic fittings do not provide electrical continuity, other Tectite fittings only provide electrical continuity when installed with metal tube.

Although manufactured to a different design, jointing tubes in sizes from 35mm to 54mm with Tectite Pro and Tectite 316 fittings is basically the same as it is at smaller sizes.

Preparation

The first thing to consider when it comes to installation of 35mm to 54mm fittings is whether you plan to demount any fittings in the system on a regular basis. If you do, then we recommend you replace the standard end cap with the appropriately sized TDX demounting end cap.

To ensure the fittings stay clean and the 'O' ring is protected from damage, never remove the fitting from its packaging until immediately prior to installation.

When it comes to tube end preparation and socket depth marking for jointing with 35mm to 54mm fittings, follow the same routine as outlined in the preliminaries, tube preparation and installation tips sections for 10mm to 28mm fittings on the previous pages.

1. Insert the tube through the end cap to rest against the grab ring.

2. Now push the tube firmly with a slight twisting action until it reaches the tube stop with a positive 'click'.

3. Ensure the depth insertion mark corresponds with the mouth of the fitting, then pull firmly on the tube to ensure that the fitting is secure.

NOTE: We recommend all systems are thoroughly pressure tested to 1.5 times working pressure before the hand-over to the customer.

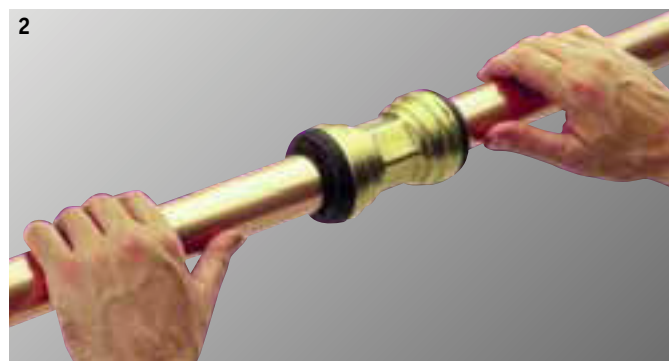

Push-fit solutions

Installation instructions

Demounting

How to demount Tectite Classic, Tectite Pro and Tectite 316 fittings from pipework.

Demounting

Tectite Classic, Tectite Pro and Tectite 316 fittings in sizes 10mm to 28mm can all be disconnected as described below. Tectite Sprint and Tectite Advance fittings are not suitable for disconnection. Ensure the system is de-pressurised and drained.



1. Place the forks of the disconnecting tool around the fitting assembly. The fork side carrying the Tectite brand logo should be positioned around the tube/pipe, with the opposite side around the neck of the fitting.

2. Squeeze the disconnecting tool with one hand until the release collar in the fitting is depressed. With the other hand, twist out the tube/pipe using the thumb as a lever against the tool to assist disconnection.

3. Check the fitting and tube/pipe for damage before remaking the joint.



4. The plastic disconnecting clip may be used where only where an occasional disconnecting facility is required.

(You cannot demount Sprint or Advance fittings)

Demounting with TDX demounting end caps

Tectite Pro and Tectite 316 fittings in 35mm to 54mm sizes are supplied with conventional black end caps. If you intend to demount the fitting on a regular basis, a TDX demounting end cap should be purchased separately and substituted for the standard end cap. A DTX Tectite end cap tool will also be required.

Due to the potentially high frequency with which TX61/TS61 stop ends may be demounted, they are supplied with the TDX end caps fitted as standard.

Demounting the fitting from the tube is a simple process when TDX demounting end caps have been installed in the fittings. Ensure the system is de-pressurised and drained.

1. To remove the tube from the fitting, insert the prongs of the Tectite DTX end cap tool in the recesses in the status indicator (2) and turn anti-clockwise fully. The status indicator will withdraw into the fitting, indicating that the fitting is in the de-mountable position. Using a 'clockwise' twisting and pulling action the tube can now be removed.

2. Before reusing the fitting, the status indicator must be returned to the mounted position (protruding).

Important: If the status indicator is not in the protruding position, the assembly will not withstand full system pressure.



Demounting end cap

If regular demounting of a particular fitting is envisaged TDX demounting end caps should be purchased separately and installed in the fitting body.

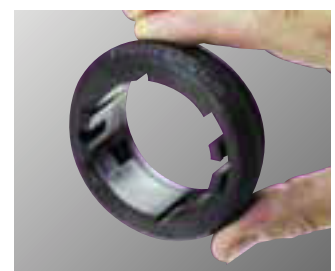

Standard black end caps

Fittings with standard black end caps can be demounted from the tube by unscrewing the end cap with the Tectite DTX end cap tool and snipping off the grab ring with side cutters, discarding both grab ring and 'O' ring. A new grab ring and 'O' ring must be used when reassembling the fitting (see the disassembly section).

Disassembly

Replacing the 'O' ring on 35mm to 54mm Tectite Pro and Tectite 316 fittings is easily achieved by disassembling the fitting.



1. Have replacement parts for the discarded items ready for insertion. Using a spanner on the fitting flats to prevent the fitting from rotating, insert the Tectite DTX end cap tool into the end cap. Turn the tool anti-clockwise to unscrew the end cap and slide it along the tube away from the fitting body.

2. Pull the tube out of the fitting body.

3. Remove and discard the 'O' ring.

4. Remove and retain the alignment ring.



5. Snip off the grab ring with side cutters and discard.

Reassembly

Tectite Pro grab rings (TX105) and Tectite 316 grab rings (TS106) are not interchangeable. Care must be taken when replacing grab rings to ensure that only the correct grab ring is used.

1. Before re-assembly have replacement parts for the discarded items ready for insertion, ensuring all the components are clean and the 'O' ring is lubricated using S130 Silicone lubricant from the XPress accessories range. Replace the components in the correct order, as shown, and check they are fully seated in the fitting body.

Note: The grab ring operates with an interference fit in the body to provide electrical

continuity. Therefore, the end cap must be tightened down flush with the fitting body.

2. Screw the end cap back into the fitting until hand tight. If resistance is felt and the end cap is not flush with the fitting body, remove the end cap and ensure the grab ring is fully located i.e. fully in contact with the alignment ring. Again screw the end cap into the fitting until hand tight. Temporarily insert a 300mm length of deburred tube into the fitting BUT NOT THROUGH the grab ring to help locate the demount tool. Tighten the end cap a further 8mm to 10mm. Remove the tube.

3. Before reinstalling the fitting back into the system, check the end of the tube for damage. If the tube is scored or damaged, remove the affected section with a tube cutter and prepare the tube end as described in preliminaries and tube preparation (page 58).

4. Reinsert the tube into the fitting up to the tube stop, ensuring the socket depth mark corresponds with the mouth of the fitting and that the finished joint is secure.

Replacement 'O' rings



TX100 replacement 'O' rings and TX105/TS106 grab rings are available (sizes 35mm to 54mm) in the event that any are lost or damaged on-site. We recommend the use of S130 Silicone lubricant grease available from the XPress range to aid insertion of the replacement 'O' ring into the fitting as these 'O' rings are supplied unlubricated.

Once the end cap has been unscrewed the other components can be removed and replaced if necessary.

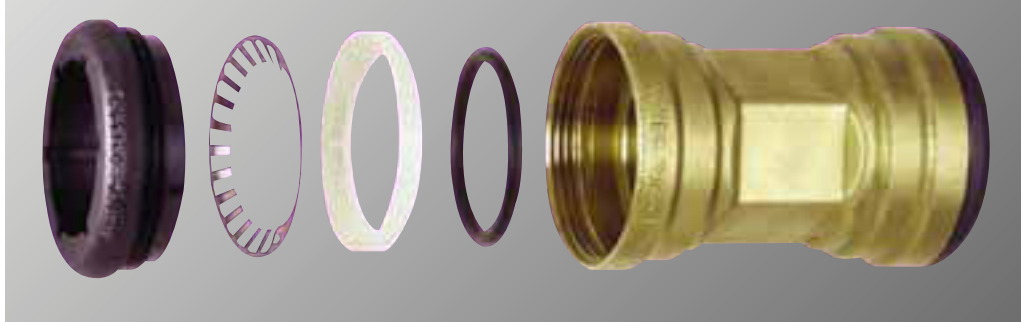



Pegler Yorkshire

Our brands:



*Also available from
Pegler Yorkshire:*



UK sales

Free Phone: 0800 156 0010
Free Fax: 0808 156 1011
Email: uk.sales@peglyorkshire.co.uk

Export

Tel: +44 (0) 1302 855 656
Fax: +44 (0) 1302 730 513
Email: export@peglyorkshire.co.uk

Technical Help

Free Phone: 0800 156 0050
Free Fax: 0808 156 1012
Email: tech.help@peglyorkshire.co.uk

Brochure Hotline

Free Phone: 0800 156 0020
Free Fax: 0808 156 1011
Email: info@peglyorkshire.co.uk

www.peglyorkshire.co.uk

Pegler Yorkshire Group Limited

St. Catherine's Avenue, Doncaster,
South Yorkshire, DN4 8DF, England.
Tel: 0844 243 4400 Fax: 0844 243 9870

Registered in England Company No. 00401507
Registered Office: Haigh Park Road, Stourton, Leeds,
West Yorkshire, LS10 1RT, England.

All brand names and logo styles are registered trademarks.
Maintaining a policy of continual product development,
Pegler Yorkshire reserves the right to change specifications, design
and materials of products listed in this publication without prior notice.

LIT.REF: 880118.01.09

