

# The Schiedel Multi System Construction Guide

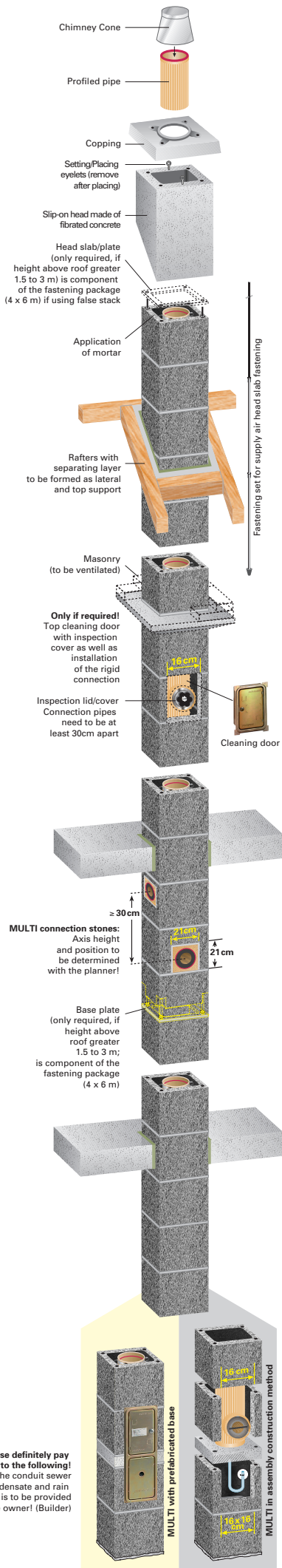

## The Schiedel solution for room sealed boilers

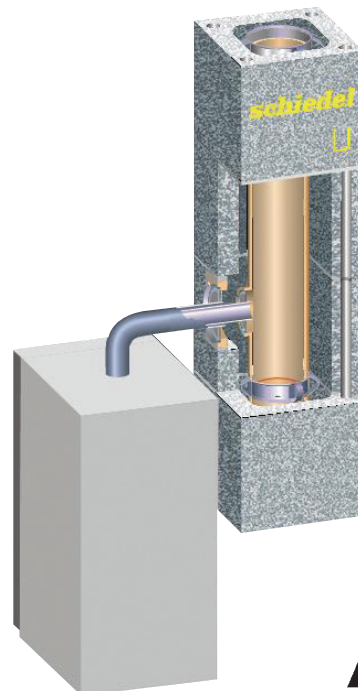

Please definitely pay attention to the following!  
 Drain to the conduit sewer for condensate and rain water is to be provided by the owner! (Builder)

MULTI with prefabricated base

MULTI in assembly construction method

## 1. Prefabricated base and condensate drain



1.1 Prepare mortar bed, set prefabricated base in mortar.



1.2 Drain to the conduit sewer to be provided by the owner/builder.



1.3 Insert overflow brake from the MULTI package.



1.4 Apply Schiedel High Temperature sealant generously in the sleeve of the profiled pipe.

## 2. Assembly after the prefabricated base up to the MULTI connection block



2.1 Place the joint protection cover onto the profiled pipe to stop mortar falling into the pipe.



2.2 Apply thin-bed mortar.



2.3 Set two outer blocks.



2.4 Remove joint protection lid with magnet on the joint smoothing tool.

## 3. Openings for MULTI connection stone



3.1 On the outer block opening mark 21 x 21 cm.



3.2 Cut opening for connection piece with angle grinder.



3.3 Mark connection position on the dry inserted profiled pipe.



3.4 On the profiled pipe opening mark 11.5 x 14.5 cm (w x h).



3.5 Produce opening with angle grinder or wet core drill.



3.6 Insert profiled pipe.



3.7 Apply Schiedel High Temperature sealant onto inner connection piece.



3.8 Mortar in outer connection part (Insert protection disc).

## 4. Standard Installation procedure



4.1 Apply Schiedel High Temperature sealant generously onto the profiled pipe.



4.2 Put joint protection cover onto the profiled pipe.



4.3 Apply thin-bed mortar.



4.4 Set two outer blocks. The blocks should be tied every metre to a structural wall.

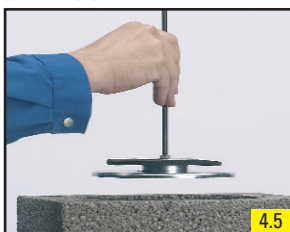

4.5 Remove the cover with the magnet on the joint smoothing tool.



4.6 Insert profiled pipe (L = 66 cm).



4.7 Float profiled pipe joint with joint smoothing tool.



4.8 Repeat Standard Installation Procedure up to the top.

**5. Top construction** Prior to starting with the top construction the slip-on head with supply air head slab must have been fitted.



5.1 Insert stoppers on underside of block. Screw two reinforcement rods together and insert them diagonally.



5.2 Pour the mortar into the reinforcement ducts. Pay attention to even axis distances.



5.3 Place the coping slab on the mortar bed.



5.4 Screw on the coping, free holes to be closed with plastic caps.



5.5 Place the cone and measure the missing pipe length.

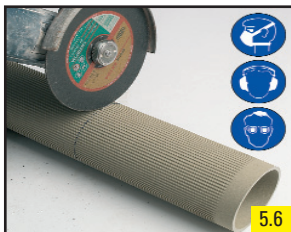

5.6 Measure from the smooth end of the pipe, mark and shorten.

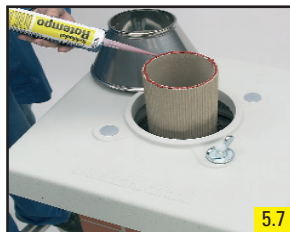

5.7 Fit pipe - smooth end pointing upwards - Apply High Temperature sealant liberally.



5.8 Slide cone over the pipe until it sits on the cover plate.

**Top inspection cover (only if required)**



Insert inspection cover.

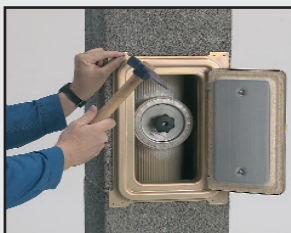

Nail and apply high temperature sealant to fix the cleaning door to the outer block.



Plaster around the cleaning door.



We recommend plastering the block to seal the chimney.

**Ceiling and roof penetration:**



Leave a gap of 40mm at ceiling / floors. Fill this gap with a non-combustible material.

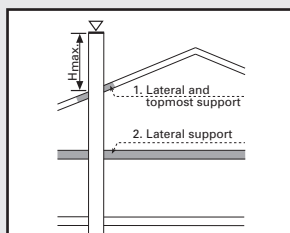
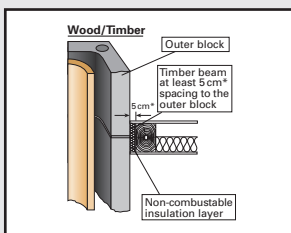

Pay attention to the lateral support.

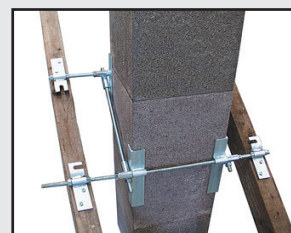

Holder for the lateral support; Particularly suitable for visible roof structure.

**Fire connection**



Insert plug-in adapter(s).



Insert insulation ring.



Smear the connection pipe with a lubricant and then slide the pipe into the adapter.

## Construction with prefabricated base. Basic construction set consisting of:



### MULTI Package

High Temperature sealant  
Chimney cone  
Overflow brake  
Installation instructions  
hand press  
Pointing device  
Joint protection cover



### MULTI pre-formed package

Cleaning door connection L = 66 cm  
Inspection cover  
Cleaning door



### MULTI stack component

Supply air coping  
Reinforcement set  
Seal mortar with  
Litre and dosage cup

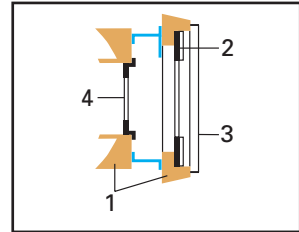

### MULTI connection block (loose, according to requirement)

1 - Connection stone  
2 - Plug-in adapter (Supply air)  
3 - Stop ring for plaster/tiles  
4 - Plug-in adapter (Waste-gas)

## General notes:

- Install the Schiedel MULTI in accordance with the installation instruction on hand. Carry out the assembly with the utmost care and attention.
- In addition, we explicitly point out the adherence to the building regulations and standards in force as well as the relevant regulations for prevention of accidents.
- The arrangement of the cleaning door and the connection height of the boilers must be known prior to commencement of the installation work.

Information for the person carrying out the work

- The prefabricated base is set into a deep mortar bed.
- The outer blocks (3 off = 1 m) are set in thin-bed mortar.

- The profiled pipes L = 0.66 m are set with the High Temperature sealant.
- Metal spacers on the pipe circumference centre the profiled pipe radially as well as vertically in the outer block.
- The pipe contact areas must be free of dirt and dust. High Temperature sealant is always to be applied generously.
- The prefabricated base is to be lowered into position ensuring the base unit is level and straight. The rope slings and the protective cover are to be removed.
- The MULTI must always be covered, in order to prevent ingress of water.

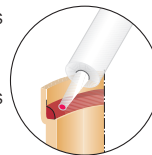

- During outer block fitting, the inner pipe must always be protected with the cover against falling mortar.
- Prior to setting the next profiled pipe, ensure that the cover is removed with the magnet on the joint smoothing tool.
- The builder is responsible for draining condensate via the conduit sewer.

Apply thin-bed mortar also in the web area

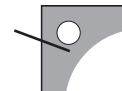

Washingbay Road,  
Coalisland, Co. Tyrone,  
BT71 4ND.  
Tel: 028 8774 0436  
Fax: 028 8774 7430  
Email: office@schiedel.co.uk  
www.schiedel.co.uk

Crowther Estate,  
Washington,  
Tyne & Wear NE38 0AQ.  
Tel: +44 (0)191 416 1150  
Fax: +44 (0)191 415 1263  
Email: sales@schiedel.co.uk  
www.schiedel.co.uk

Carrickmacross,  
Co. Monaghan,  
Ireland.  
Tel: (042) 9661766  
Fax: (042) 9662494  
Email: office@schiedel.ie  
www.schiedel.ie